

Punch Needle Kit - Mandala

Kit Include

- › 1 x printed fabric
- › 14 x embroidery threads
- › 1 x punch needle
- › 2 x threaders
- › 1 x 20cm bamboo hoop

Tips

- Prepare the fabric on the embroidery hoop by separating the 2 circles and laying the fabric over the inner one. Place the larger circle over the top and press down to secure the fabric. Adjust the fabric position to ensure the design is centred. Tighten the screw and gently pull the fabric edges to ensure it's taut. Do not pre wash the fabric.
- Embroidery thread is made up of 6 strands of thread twisted together. We recommend using all 6 strands of thread cut into 1 meter lengths to be more manageable.
- Begin your punch needling by following the guide image for colour and stitch reference.
- To complete your hoop, turn it over and trim the excess fabric from the edges. Alternatively, trim the fabric and fold it over the inner part of the back side of the hoop. Use hot glue to secure the fabric.

Guide Image

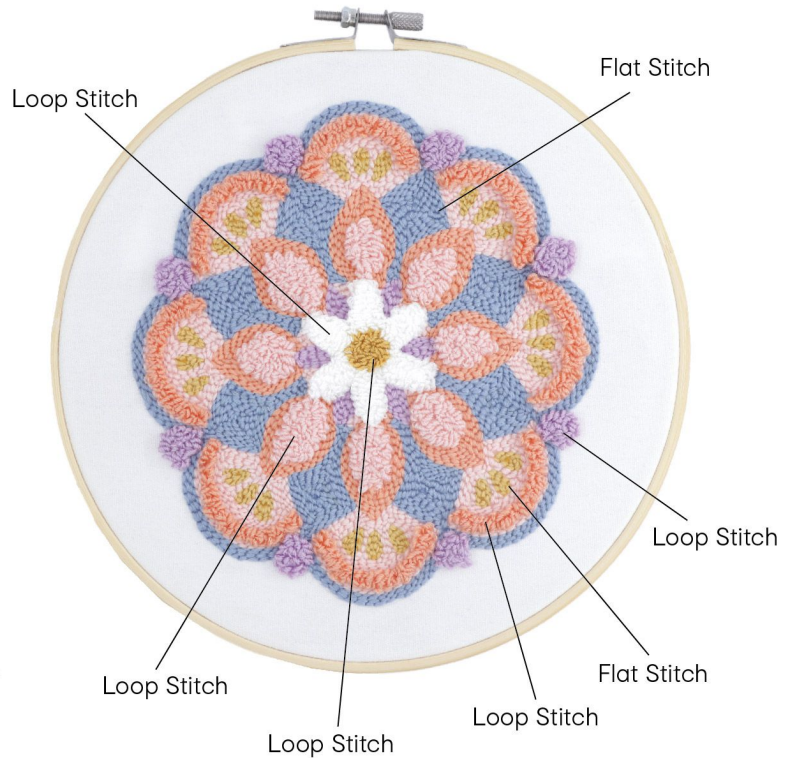

How To Thread A Needle

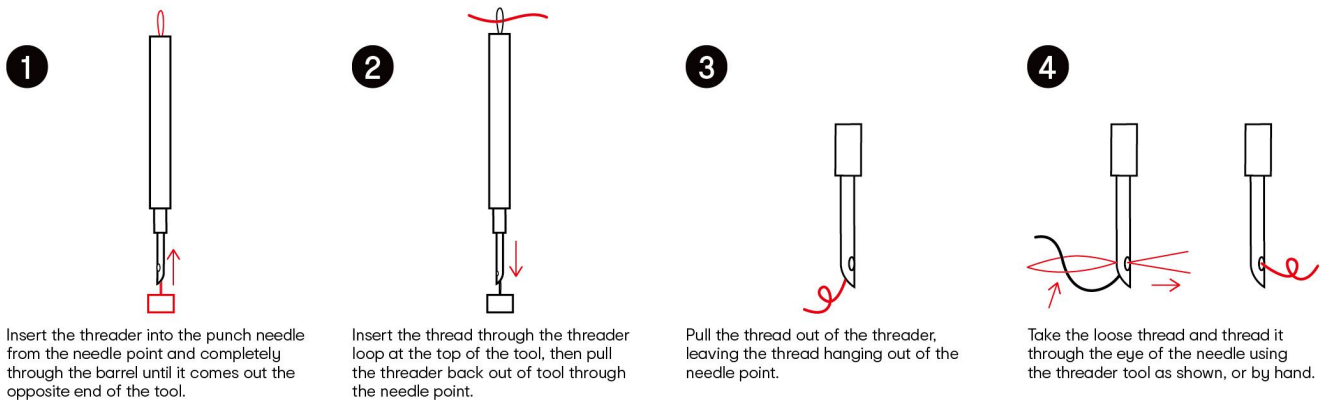

Flat Stitches

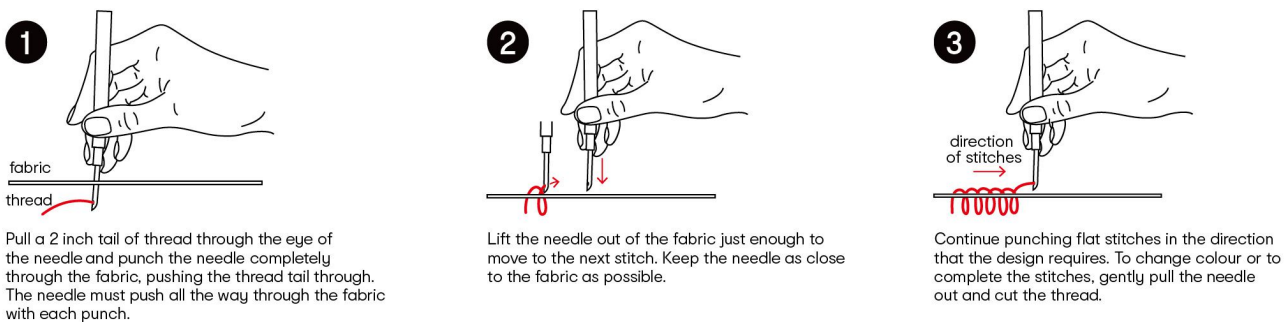

Loop Stitches

