

Adult assembly and supervision required

Keycode: 43-305-346

1

Assembly complete

PARTS NEEDED

- 1x1
- 2x24
- 4x2
- 3x5
- 6x6
- 6x1
- 7x4
- 8x1

Insert into the hole according to the top view diagram

Connect at the 4th hole from top

2

Assembly complete

PARTS NEEDED

- 1x1
- 2x12
- 3x4
- 6x3
- 6x1
- 7x4

Insert into the hole according to the top view diagram

Connect at the 7th hole from top

3

Assembly complete

PARTS NEEDED

- 1x1
- 7x11
- 8x6
- 3x11
- 6x2
- 4x2
- 5x4
- 2x26

Connect at the 7th hole from top

Insert into the hole according to the top view diagram

4

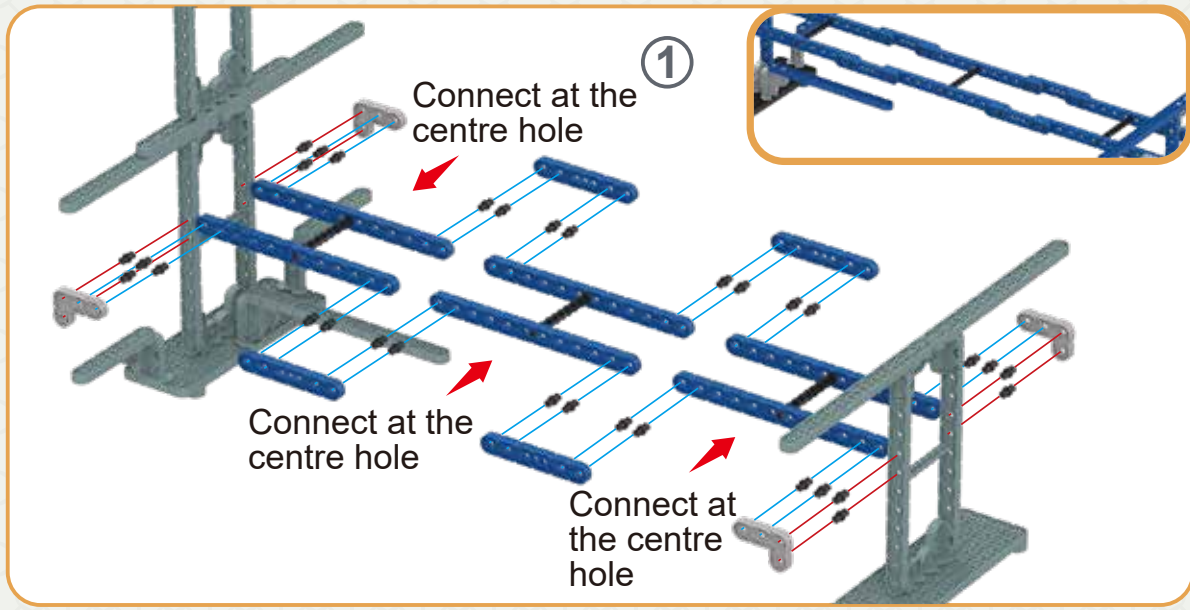

5



Maintain exactly 2cm gap between outer and inner track tube throughout the whole setup for smooth ball movement

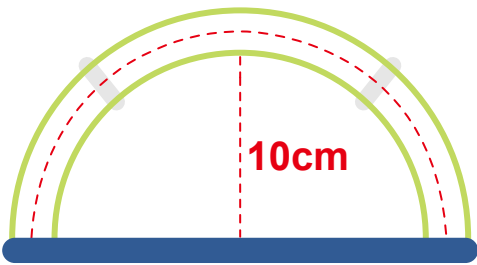

Build the flexible track exactly 10cm away from the main frame.

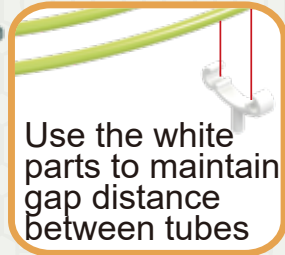
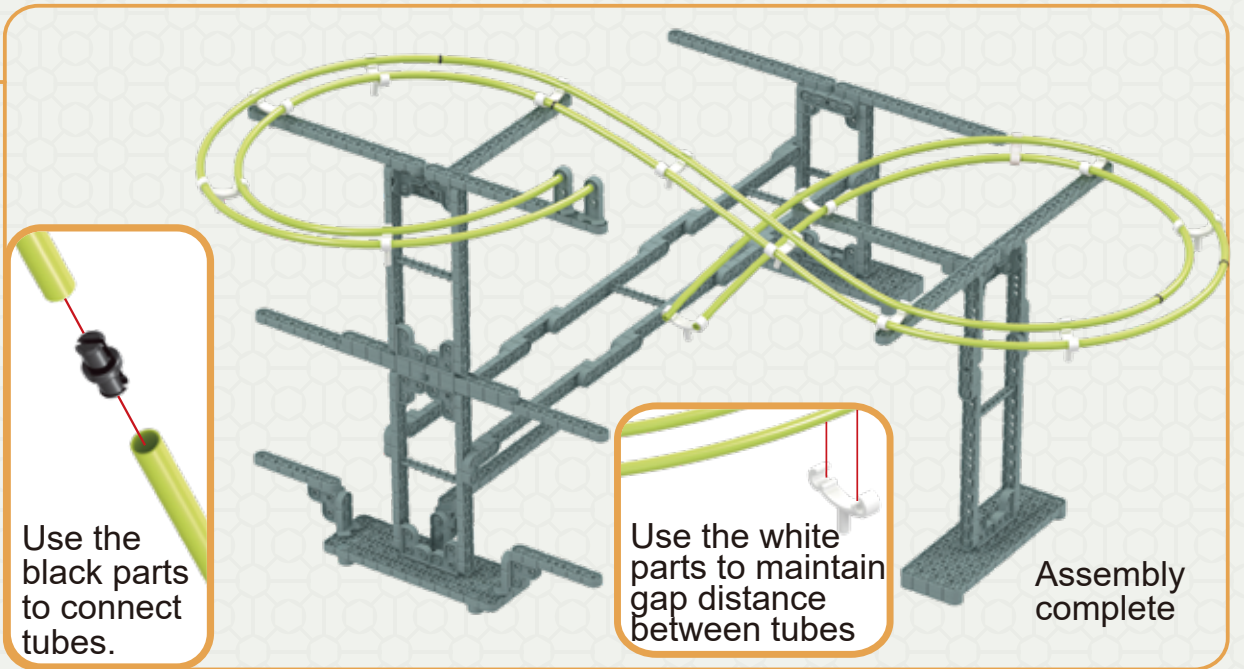

Assembly complete

6

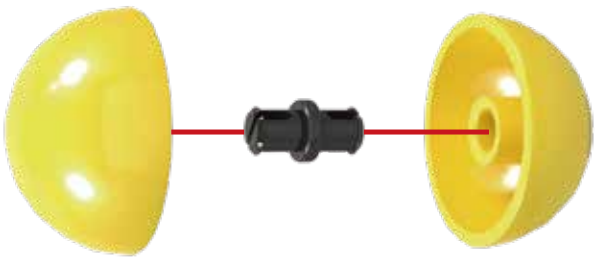
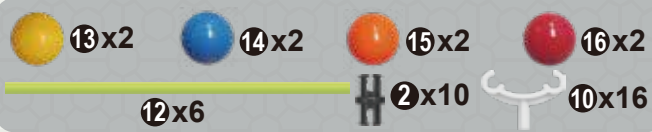

Use the black parts to install running balls.

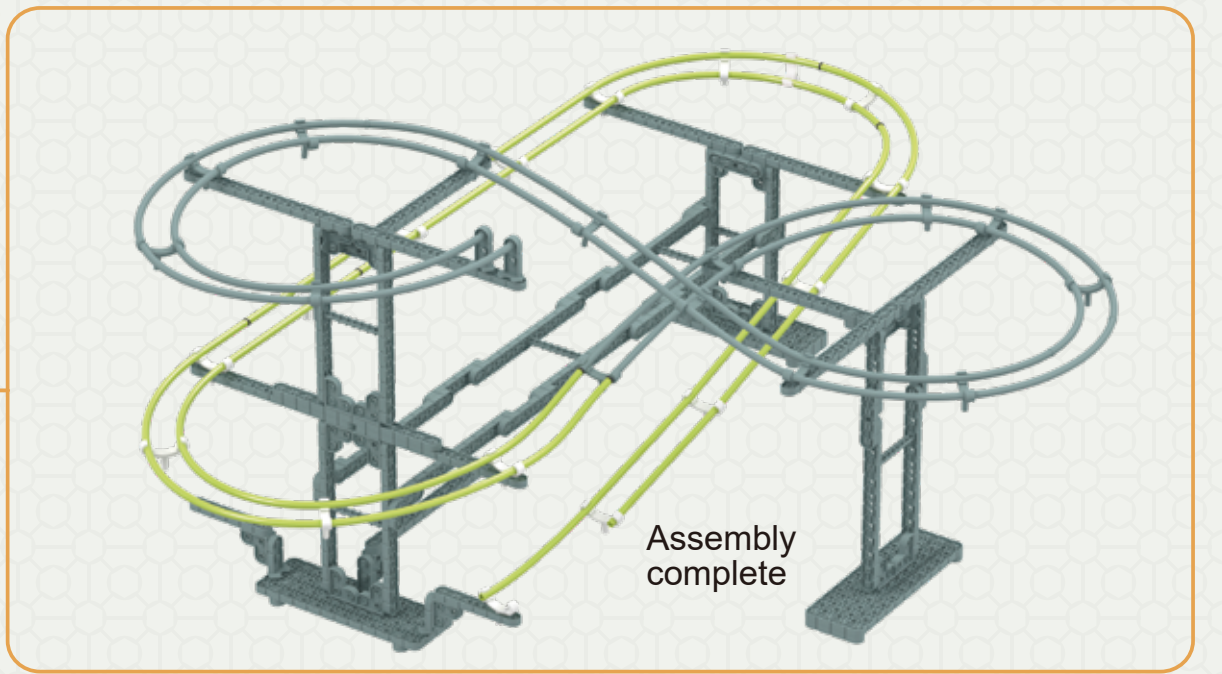

7

