

# anko

## Paper Flowers Instruction Manual

### Kit Includes

- › 5 x coloured crepe paper
- › 4 x flower shape templates
- › 8 x wire stems
- › 1 x green tape
- › 2 x tubes of glue
- › 8 x flower core foam ball
- › 1 x instruction sheet

### Tips

- › Each flower requires 6 petal shapes, 1 yellow stamen fringe shape, 1 flower center shape and 1 green flower core shape.
- › Ensure glue is dried before handling. Use a hot glue gun to speed up the drying time.
- › Mix and match colours to create new colour combinations.
- › Pre-cut flower shapes using the templates and guide below.



Guide Image

### Flower Shapes Template Guide

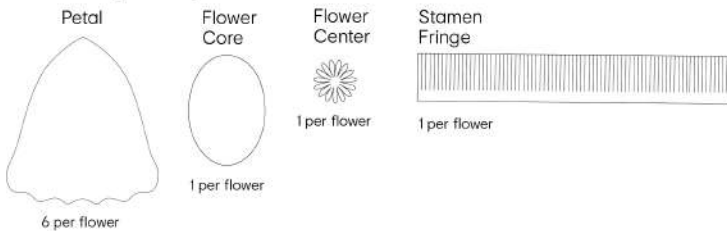

### How To Make A Paper Flower

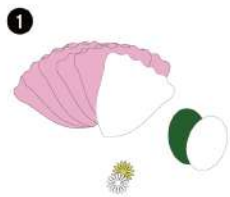

Use the flower shape templates provided to cut the petals, flower core and flower center from the crepe paper.



Insert the wire stem into the flower core foam ball, glue it into place and allow to dry. Attach and twist the green flower core shape around the ball and wire and secure it using green tape.



Glue the flower center on top of the flower core ball as shown.

# anko

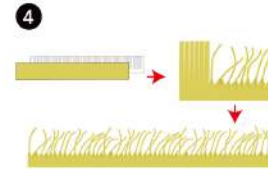

Cut the stamen shape and snip along one edge to create a fringe shown above.

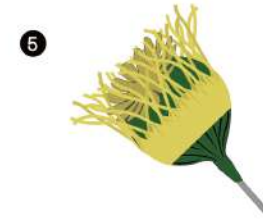

Wrap the stamen fringe around the flower core and secure it with glue. Trim any excess fringe.



Twist the petals as shown to create a textured effect. Open the petals buck up ready to add to the flower core.

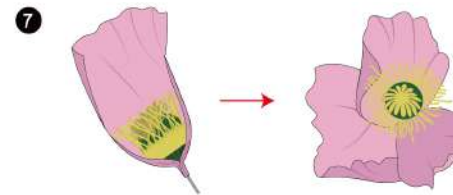

Gently gather and pleat the bottom edge of the petals and shape them to cup inwards slightly. Pinch in place and attach below the flower core and glue into place.



Continue adding layers of petals on top of one another until your flower is the size you'd like.

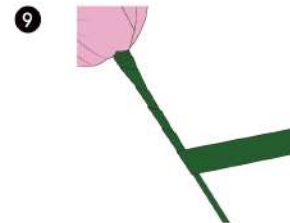

Wrap green crepe paper around the wire stem and secure with green tape.

10 The flower is complete. Continue with remaining crepe paper to make more flowers, then display them in a vase or bouquet.



MADE IN CHINA  
CUSTOMER SERVICE:  
KMART AU: 1800 124 125  
KMART NZ: 0800 945 995  
TARGET AU: 1300 753 567

KEYCODE 43-342-631