

anko

Coloured Ceramic Plate Instruction Manual

Kit Includes

- › 1 x embossed ceramic plate
- › 6 x paint markers
- › 1 x instruction sheet

Tips

- › Clean and dry the plate thoroughly before beginning.
- › Ensure paint is dry before moving to the next colour.
- › Use a clean damp cloth to remove paint errors while paint is still wet.
- › The painted plate is for decorative purpose only. Not suitable for serving food or washing.



Guide Image

How To Paint A Ceramic Plate

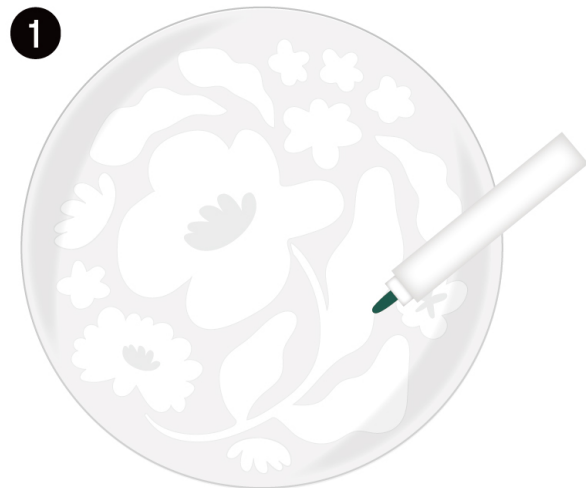

Begin colouring using any colour paint marker you desire. Fill the debossed shapes with colours matching the guide image.



Continue colouring using remaining colours, leaving paint to dry between each colour. Once all of the paint is dry, the plate is ready to display.

MADE IN CHINA

CUSTOMER SERVICE:

KMART AU: 1800 124 125
KMART NZ: 0800 945 995
TARGET AU: 1300 753 567

KEYCODE: 43-342-662