

HOW TO CLEAN THE DUST CANISTER AND FILTER:

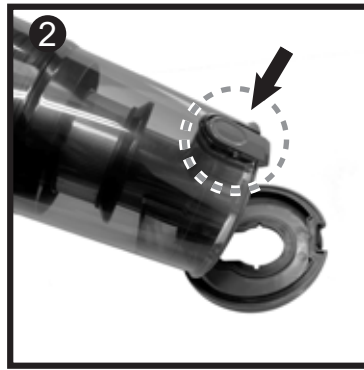

To empty the dust canister, first remove the extension tube from the end of the dust canister by pressing the release button and pull the tube out.



Empty the dust canister into a rubbish bin by pressing the **Trap Door Release Button**.



To clean the filters, grasp the tab on top of the **Main HEPA Filter (B)** and pull it up and out of the mesh filter.



To remove the **Mesh Filter (A)**, grasp the wire handle, swing up and pull it straight up and out.

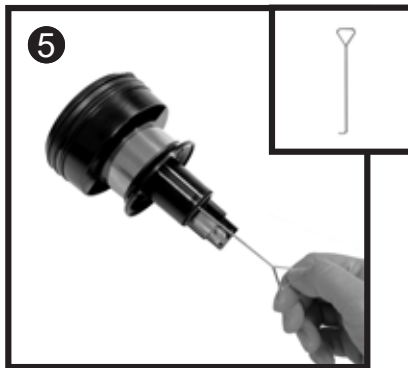

Use the supplied **Wire Hook tool** to remove any hair or fluff etc. from the cavities, then wipe over with a very lightly moistened (not wet) clean cloth and mild detergent. **DO NOT wash it as there are electrical contacts inside this part.**



Only wash **Main HEPA Filter (B)** if it is very dirty. Set aside to **AIR-DRY**.

It is recommended to replace the main HEPA filter every 6 months or sooner if required. Please visit hegroup.com.au to purchase the spare parts.

HOW TO CLEAN THE MOTORISED FLOOR HEAD:



Turn over the floor head to access the **Small Tab** on the left hand side.

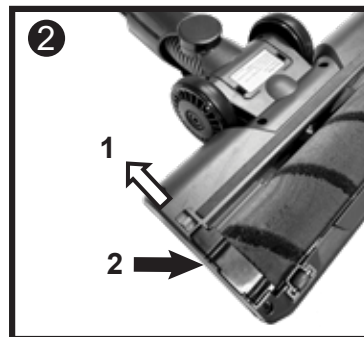

Slid it back to unlock the **Rotary Brush Holder**. The holder will pop up when released. Grasp the **Rotary Brush** and lift it up and out.



Remove any hair, thread and debris etc. that may have caught around the end bearings, wheels or stuck in the openings.

If you are missing a part or having troubles when assembling the fan, please feel free to call our friendly customer service team on our toll free number: 1300 105 888 or via email info@hegroup.com.au. We will be glad to assist you.

anko

Cordless Stick Vacuum For Household Use Only



Model No.: VC109A
Rev 2

Note: The specifications and/or components of this appliance are subject to change without prior notice.

If any Accessories should fail during use, please call 1300 105 888 (Australia) or 09 8870 447 (New Zealand) for an immediate replacement. This will save you from returning the product to the store.

If we can assist you in any other way, please feel free to contact us.

1	Warnings	3
2	Safety Directions	3
3	Transporting your Vacuum	6
4	Components	6
5	Assembly	7
5.1	Attaching and removal of Battery Pack	7
5.2	Attaching the Extension Tube	8
5.3	Removing the Extension Tube.....	8
5.4	Attaching the Motorised Floor Head	8
5.5	Removing the Motorised Floor Head.....	9
5.6	Using Without the Extension Tube.....	9
5.7	Tools / Tool Holder	9
5.7.1	Crevice / Brush tool.....	9
5.7.2	Upholstery Tool	10
5.7.3	Tool Holder.....	10
5.8	Charging.....	11
6	Using the Vacuum Cleaner	12
6.1	On / Off	12
6.2	Speed Control	12
6.2.1	Default Mode - Auto.....	12
6.2.2	Manual Mode.....	13
7	Indicator Lights	13
7.1	Jammed Floor Head Brush	13
7.2	Filter Blockage / Air Flow Blockage	14
7.3	Charge Fault indicator.....	14
7.4	Main Fault indicator.....	15
7.5	Battery Fault indicator.....	15
8	Emptying the Dust Canister	16
9	User Maintenance	16
9.1	Cleaning the Filters	16
9.2	Cleaning Dust Canister	19
9.3	Cleaning Filter Holder	20
9.4	Cleaning the Vacuum Cleaner Body and Tools	20
9.5	Cleaning the Motorised Floor Head.....	20
10	Storage	22
11	Troubleshooting	22
12	Warranty Against Defect	24

1 Warnings

Before using this appliance, read and follow all warnings and instructions in this manual, even if you are familiar with this product.

This appliance is not intended for use by persons (including children) with reduced physical, sensory, or mental capabilities, or lack of experience and knowledge unless they have been given supervision or instruction concerning the use of the appliance by a person responsible for their safety.

Children should be supervised to ensure that they do not play with the appliance.

2 Safety Directions



Please read this instruction manual carefully before first use. It is advisable to keep this instruction manual for future reference.

DO NOT vacuum water, wet objects, liquids, ashes, hot coals, cigarette butts, matches or any hot, smoking or burning objects, etc.

DO NOT pick up flammable or combustible materials (i.e., lighter fluid, petrol, kerosene, etc.) or use in the presence of explosive liquids or vapour.

DO NOT pick up toxic material (i.e., chlorine bleach, ammonia, drain cleaner, etc.)

DO NOT vacuum Toner (for laser printers, copy machines etc.) as there is a risk of fire and explosion.

DO NOT vacuum plaster dust, cement dust etc. as the filter will block very quick.

DO NOT use the vacuum without the filter fitted.

DO NOT store or use the appliance near high-temperature areas.

DO NOT run over the charger cable with the vacuum cleaner.

DO NOT use the vacuum cleaner if it is blocked. Turn off and clear all blockages before continuing.

DO NOT use the vacuum cleaner with a blocked filter. Clean filter before continuing. (refer to User Maintenance section).

DO NOT use the vacuum cleaner if the appliance malfunctions, abnormal noise, smell, smoke, is dropped or damaged in any manner or any breakage is found during the operation.

For electrical safety, any repairs to the product must be performed by a qualified electrical person only, or the product must be disposed of.

DO NOT misuse the Charger Cable. Never pull the appliance by the cable or pull to disconnect it from the outlet. Instead, grasp the charger body and pull to disconnect.

DO NOT use the vacuum cleaner to pick up large objects, hard or sharp objects such as glass, nails, screws, coins, etc. that are likely to cause damage.

DO NOT use with damaged Charger Cable or Charger Body.

DO NOT use vacuum cleaner if it has been dropped, damaged, left outdoors, or dropped into liquid (water etc.)

DO NOT handle Charger or vacuum cleaner with wet hands.

DO NOT put any objects into openings.

DO NOT use with any openings blocked and do not restrict airflow.

DO NOT use without the filter in place.

DO NOT attempt to modify this product in any way.

DO empty the Dust Canister regularly for optimal operation of the vacuum.

DO keep hair, loose clothing, fingers, feet, and body parts away from openings or moving parts.

DO disconnect the Charger from the power supply when not in use,

DO use only on dry, indoor surfaces.



Indoor Use Only.

DO use only as described in this manual. Use only the manufacturer's recommended attachments.

DO Keep Charger Cable away from heated surfaces.

DO Keep all openings free of dust, lint, hair, and anything that may reduce airflow.

DO use extra care when vacuuming on stairs.

DO keep your work area well lit.

DO store your appliance indoors in a cool dry area.

DO ensure children and babies cannot play with plastic bags or any packaging materials.

DO operate the Charger from a power source of the same voltage, frequency and rating as indicated on the product identification plate.



WARNING

Only use the Battery Charger which was supplied with this appliance.
Model No. ZD024M350080AU 100–240V~ 50/60Hz 0.8A Output: 35.0V $\overline{=}$ 800mA

Battery Pack Specification: Part No. VC109

Type: Li-ion, 29.6Vd.c., 2200mAh

Consumers are cautioned against using and/or purchasing counterfeit and/or inferior-quality batteries. These batteries have the potential to cause fire, personal injury, and/or damage to property. These batteries are typically found on online-auction websites or from other retailers and are known to pose a potential safety risk.

Never try to recharge Non-Rechargeable batteries as they may explode, catch on fire, or cause personal injury and/or damage to property.

- May explode if disposed of in fire.
- To prevent injury or burns, do not allow metal objects to contact battery terminals.
- Do not use or store in temperatures above 40°C.



The Battery Pack must be removed from the vacuum cleaner before disposal.

Contact your local waste management authority for more information on Battery Recycling and disposal regulations in your area.



This symbol on the product or its packaging indicates:

Do not dispose of electrical appliances or batteries as unsorted municipal waste, use separate collection facilities. Contact your local council for information regarding the collection systems available. If electrical appliances are disposed of in landfills or dumps, hazardous substances can leak into the groundwater and get into the food chain, damaging your health and well-being. Please contact your local council or regional authority for more information on the collection, reuse, and recycling programmes.

If a third party uses this appliance, **DO** supply the instruction manual with it.

No liability can be accepted for any damage caused by non-compliance with these instructions or any other improper use or mishandling of the appliance.

This product has not been designed for any uses other than those specified in this manual.

ONLY for domestic use. Industrial or commercial use invalidates the warranty.

Read and Save These Instructions

3 Transporting your Vacuum

To move your vacuum cleaner from room to room, unplug the unit and carry using the carry handle.

Never pull or carry the vacuum cleaner by its Charger cable.

Never carry the vacuum cleaner with the accessories / Tools.

4 Components

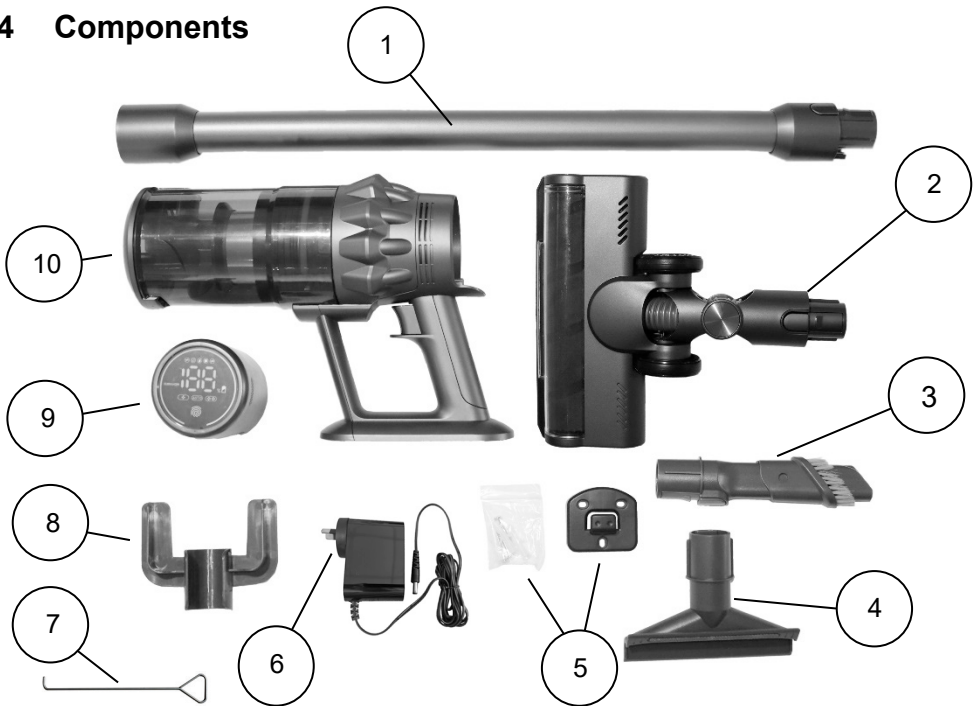

1	Extension Tube	6	Battery Charger - ZD024M350080AU
2	Motorised Floor Head	7	Cleaning Wire Hook Tool
3	Crevice / Brush Tool	8	Tool Holder
4	Upholstery Tool	9	Control Panel / Rechargeable Battery Pack
5	Wall Mount Bracket, Plugs and Screws	10	Dust Canister / Vac Body

Note: The specifications and/or components of this appliance are subject to change without prior notice

5 Assembly

5.1 Attaching and removal of Battery Pack

Note: Charge the Vacuum Cleaner for at least 5 hours x 2 times before first use.

Only use the Battery Charger which was supplied with this appliance.

Slide the battery pack onto the back of the vacuum cleaner handle and push all the way in until it locks in place as shown:

Note: The Battery can only be fitted in one direction.



Other than for maintenance, there should be no need to remove the battery pack once fitted, however, when you do need to remove it, press the release button located underneath the battery pack, and at the same time, slide the battery straight out.



5.2 Attaching the Extension Tube

Insert the top end of the Extension Tube into the mating hole in the end of the dust canister body ensuring the locating guides are aligned, then push inward until it locks into place.



5.3 Removing the Extension Tube

To remove the Extension Tube, press the locking button to release then pull the tube straight out.

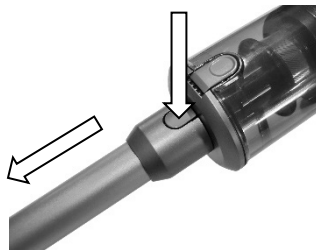

5.4 Attaching the Motorised Floor Head

To attach the motorised floor head to the other end of the extension tube, insert the end of the Extension Tube into the end of the Floor Head, ensuring the locking tabs are aligned, then push inward until it locks into place.

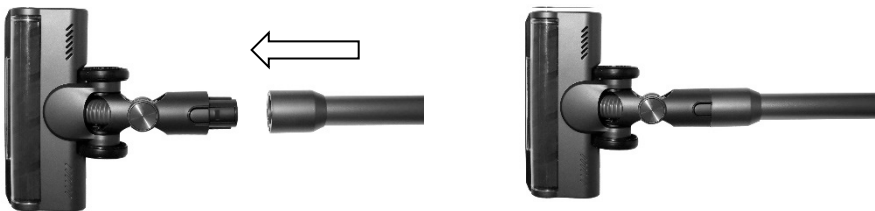

5.5 Removing the Motorised Floor Head

To remove the Motorised Floor Head, grasp the Motorised Floor Head, press the locking button to release and then pull the Tube straight up and out.



5.6 Using Without the Extension Tube.

The vacuum cleaner can be used without the extension tube by attaching the Accessories and Motorised Floor Head directly to the vacuum cleaner.

To attach and remove, follow the same steps as if using the Extension tube.



5.7 Tools / Tool Holder

5.7.1 Crevice / Brush tool

Crevice / Brush tool is for cleaning furniture and into corners etc.

To use the Brush tool, slide the brush down until it locks in place.

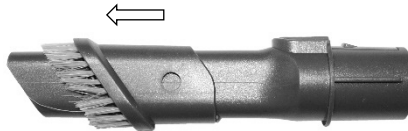

To use the Crevice tool, press the release button in to unlatch and slide the brush up until it locks in place.

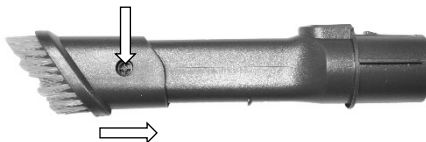

To fit the tool, line up with the end of the hand vac and push in.

Note: The tool can also be used on the end of the Extension Tube.

To remove, press the locking button to release and then pull the tool straight out.

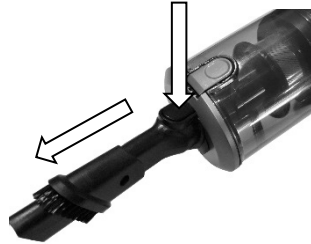
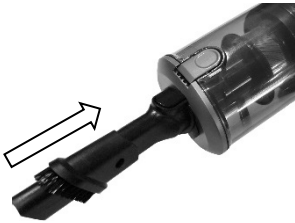

5.7.2 Upholstery Tool

The Upholstery tool is used for cleaning sofas and curtains, etc.

To attach and remove, follow the same instructions as used for the Crevice / Brush Tool.



5.7.3 Tool Holder

There is a tool holder which clips onto the extension tube and which the tools are then stowed on the holder.

To attach, take the tool holder and clip it onto the extension tube with the posts facing upward.

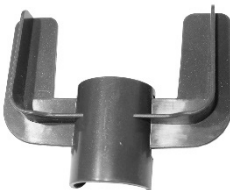

5.8 Charging

The battery can be charged whilst the vacuum cleaner is stowed on the wall hanging bracket.

Note: Refer to the section “Storage” for instructions on mounting the Storage Bracket to the wall.

For charging the battery, insert the small plug end of the battery charger into the socket of the battery as shown.



Plug the Battery Charger into the power point and switch it on.

During Charging, the digital readout will display the percentage of charge.



The digital readout will show 100% when fully charged.

When the battery is fully charged, switch off and unplug the battery charger from the power supply and from the battery.

When fully charged, the Vacuum Cleaner is ready for use.

IMPORTANT:
NEVER BLOCK ANY VENTS OR OPENINGS OR COVER THE UNIT WHILE CHARGING.

6 Using the Vacuum Cleaner

6.1 On / Off

To use the Vacuum Cleaner, assemble the unit as previously instructed and ensure the battery is fully charged.

To switch on, grasp the handle then squeeze and release the trigger on the handle.



The vacuum cleaner will start in the default power mode (Auto).

Squeeze and release the trigger again to turn off.

Note: The vacuum cleaner cannot be started when charging.

6.2 Speed Control

6.2.1 Default Mode - Auto

When the vacuum cleaner is first switched on for use, it will default to “Auto” mode setting as indicated by the word “Auto” illuminating on the control display. This will remain on this setting unless manually changed.



During use in Auto mode, depending on the floor surface and the amount of dust the vacuum cleaner is picking up, the vacuum cleaner suction will automatically adjust to the required power.

6.2.2 Manual Mode

Whilst the vacuum cleaner is running, touch and release the Fingerprint Button to cycle through the power range from Auto to High to Low and back to Auto.

The Indicator lights will illuminate depending on which mode you have selected.

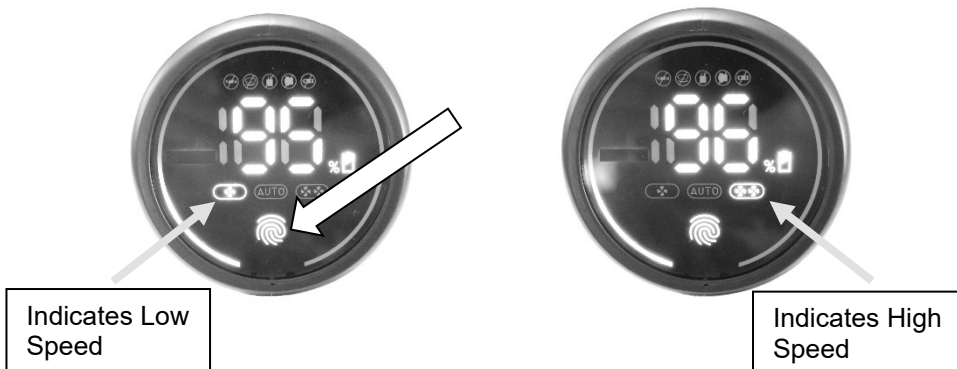

Note: Using Maximum Power will use the battery power quicker than in the Default Mode setting.

7 Indicator Lights

7.1 Jammed Floor Head Brush

The vacuum cleaner is fitted with a sensor that detects if the floor head rotary brush gets jammed.

If the brush gets jammed, the Floor Head will turn off and an indicator light on the control panel will blink on and off.



Immediately turn the vacuum cleaner off and proceed to clear the jam by referring to the “Cleaning the Motorised Floor Head” section in this manual.

Once cleaned and free from a jam, you can start the vacuum cleaner again.

7.2 Filter Blockage / Air Flow Blockage

The vacuum cleaner is fitted with a sensor that detects if the main filter is blocked or if there is an airflow blockage.

If the main filter becomes blocked, or if there is an airflow blockage in the tube or floor head, the “Blocked Filter” indicator light on the control panel will illuminate for 2 – 3 seconds before the whole unit turning off.

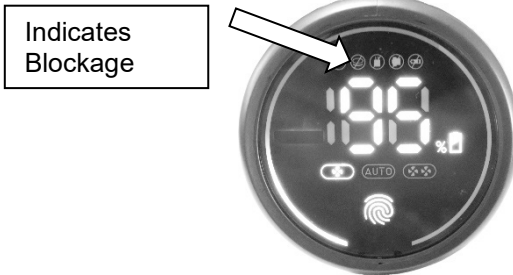

Important: Do not use again until you have rectified the issue as follows:

Check for blockages in the floor head and tubes etc. If no blockages are found, clean the filter.

Refer to the “Cleaning the Filter” section in this manual on how to clean or replace the main filter.

If the vacuum cleaner has overheated and turned off, after checking for blockages and after cleaning the filters, allow the vacuum cleaner to cool down for 1 hour before using again.

7.3 Charge Fault indicator.

The Charge Fault indicator light will illuminate should there be a problem with the charger power / current.



Important: If this indicator light should illuminate, immediately turn off and unplug the battery charger and call customer service.

7.4 Main Fault indicator

The Main Fault indicator light will illuminate should there be a problem with the motor such as overheating, excessive current draw etc.



Important: If this indicator light should illuminate, immediately turn it off and check for blockages and / or a blocked filter and remedy.

If after cleaning and allowing the unit to cool down for at least 1 hour the error returns after a few minutes, call customer service.

7.5 Battery Fault indicator

The Battery Fault indicator light will illuminate should there be a problem with the batteries such as overheating.



Important: If this indicator light should illuminate, immediately turn off and unplug the battery charger (if charging), or turn off the vacuum cleaner (if in use) and allow the batteries to cool down for approximately 1 hour in a cooler environment.

Important: Ensure that the batteries are not covered with anything, not in direct sunlight, not next to a heat source, or being charged or used in a hot room.

8 Emptying the Dust Canister

To Empty the dust canister, first remove any accessories or the extension tube from the end of the dust canister then take the vacuum cleaner to a dustbin.

Press the release button on the dust canister and the trap door will swing open emptying the contents into the bin.



To close the trap door, close it manually until it clips shut.

Empty the Dust Canister as frequently as possible or when the suction power is reduced or after use for optimum performance.

9 User Maintenance

WARNING: The battery must be removed from the vacuum cleaner before any maintenance, cleaning, or replacement of parts.

NOTE: To maximise the performance of your vacuum cleaner, you should clean the filters regularly.

If the filter is broken or worn, replace it before continuing to use the vacuum.

A new filter can be purchased from our Customer Service. You can call our customer service number: 1300 105 888 (Australia) and 09 8870 447 (New Zealand), or via email at info@hegroup.com.au

9.1 Cleaning the Filters

Important Note – The Filters must be cleaned regularly for the best suction performance and to prevent overheating and damage to your vacuum cleaner.

Cleaning is best done at the same time as emptying the dust Canister after you have finished vacuuming for the day.

NOTE: Never use the vacuum cleaner with a wet or damp filter or without the filter fitted.

Using a wet or damp filter will damage the filter, will cause severe damage to the vacuum cleaner, and will void your warranty.

Only wash the filter if it is very dirty, otherwise, just tap the edge of the filter on a hard surface to dislodge any dust and debris.

To access the filter, first remove the dust canister by grasping the dust canister with one hand, and while holding the vacuum cleaner body with the other hand, rotate the base to the left and then pull down and away.



Grasp the two lugs on top of the filter with your thumb and index finger and pull the filter up and out of its holder.



Grasp the wire handle, swing up and pull the filter holder straight up and out.

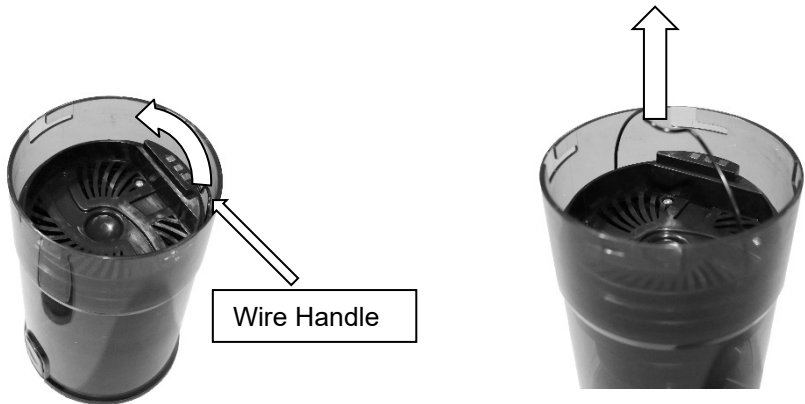

Wire Handle

Do Not Wash the Filter Holder or get it wet



Only wash the filter if it is very dirty, otherwise, just tap the edge of the filter on a hard surface to dislodge any dust and debris.

If needed, wash the filter in warm mild soapy water, rinse in clean fresh cold water and let them completely dry.

DO NOT scrub the filter or place it in a dishwasher.

DO NOT use a hairdryer to dry the filter.

Refit the filter (or replace with a new one) to the Filter Holder, then refit the filter holder to the dust canister in the reverse method used for disassembly.



Note: The filter holder can only be fitted in one position. Align the bottom part of the filter holder post with the mating slot in the bottom of the dust canister then push down firmly.

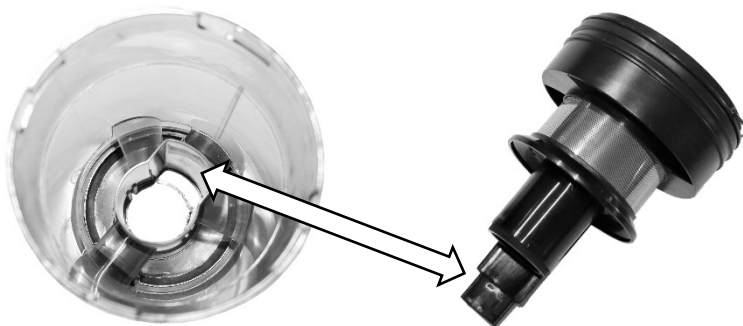

9.2 Cleaning Dust Canister

Remove the dust canister as described previously and remove the filter and filter holder as described previously.



Wash the dust canister in warm mild soapy water, rinse in clean fresh cold water and let completely dry.

DO NOT scrub the dust canister or place it in a dishwasher.

DO NOT use a hairdryer to dry the dust canister.

Reassemble and Refit the filter and filter holder to the dust canister, then refit the dust canister to the vacuum cleaner.

Align the arrow with the line on the side of the dust canister, push the duct canister and vacuum cleaner together then rotate to lock in place.



9.3 Cleaning Filter Holder

Remove the dust canister as described previously and remove the filter and filter holder as described previously.

DO NOT WASH or get the filter holder wet as there are electrical contacts inside this part.

To clean, use a brush to remove any pieces of large debris and dust, or if needed, use the supplied Wire Hook tool to remove any hair or fluff etc, from the cavities, then wipe over with a very lightly moistened (not Wet) clean cloth and mild detergent.



Then use a dry clean cloth and wipe all over to remove any traces of moisture.

9.4 Cleaning the Vacuum Cleaner Body and Tools

Do not clean the vacuum cleaner, components or accessories using petrol or any other flammable liquid or solvents, etc.

Clean only the outside of the vacuum cleaner.

Use only a moist cloth and mild detergent for cleaning the vacuum cleaner, components, and accessories.

After cleaning, wipe the moisture off the vacuum cleaner, components, and accessories with a dry cloth.

Do Not place accessories / components in a dishwasher.

9.5 Cleaning the Motorised Floor Head

The Rotary Brush in the floor head can be removed for easy cleaning and removable of hair etc.

Ensure the Floor Head is removed from the extension tube or vacuum cleaner first.

Turn over so that the bottom face is facing up.

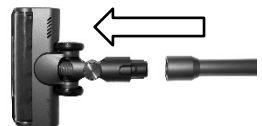

There is a small tab on the bottom which needs to be slid backward to unlock the Rotary Brush Holder. The holder will pop up when released.

When released, grasp the Rotary Brush Holder, and lift it up and out.

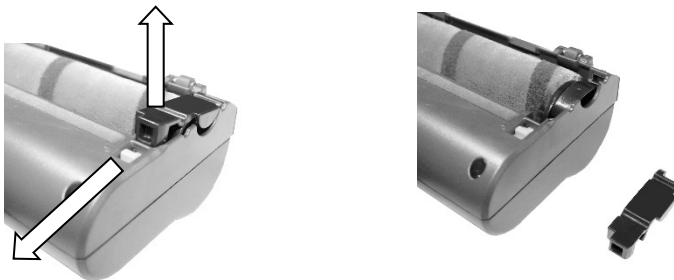

Grasp the end of the Rotary Brush and lift upward and to the side to remove.

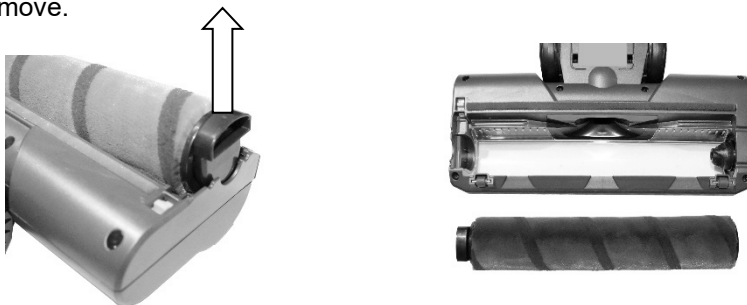

Remove any hair, thread, and debris etc. that may have caught around the brush, end bearings, wheels or stuck in the openings.

After cleaning, refit the brush in reverse order to disassembling.

Note: the brush can only be fitted in one direction.

Refit the Rotary Brush Holder by sliding the end into the slot first, then push down until the brush holder locks in place.

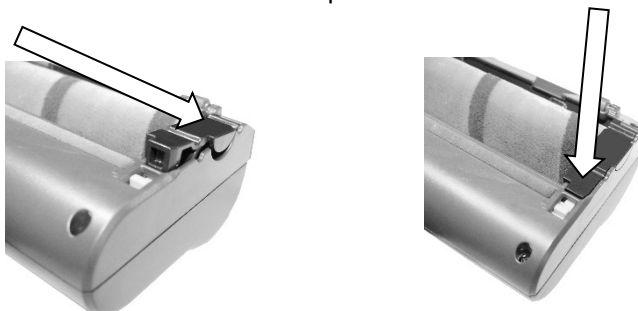

10 Storage

There is a Storage Hanging Bracket supplied with screws and wall plugs should you prefer to hang the vacuum cleaner on the wall.

To install the Storage Hanging Bracket, position the Storage Hanging Bracket on the wall, near a power point and at a suitable height where the vacuum cleaner will not touch the floor.

Mark the screw holes through the Storage Hanging Bracket onto the wall.

Using a suitable drill (wood drill bit for a timber wall, or masonry drill bit for brick / concrete walls, drill holes $\text{\O}6\text{mm}$ and 35 - 40mm deep.

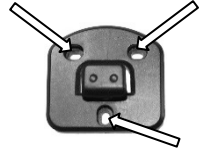

Insert the plastic wall plugs into each hole and gently hammer in until they are flush with the wall, place the Storage Hanging Bracket over the holes then insert the screws and tighten up. Do Not Overtighten.

Hang the vacuum cleaner as shown:



11 Troubleshooting

Will Not Switch On	Check that the battery is fitted correctly and fully charged.
	The battery or motor may have overheated. Refer to sections below "Main Fault" and "Battery Fault" for remedy.
The floor Head turned off and the indicator light flashing	The floor Head brush is jammed. Ensure the Vacuum Cleaner is switched off then refer to section "7.1" in this manual for further instruction.

<p>Filter Blockage / Air Flow Blockage indicator light flashes and then the unit turns off</p>	<p>Ensure the Vacuum Cleaner is switched off then refer to section "7.2" in this manual for further instruction.</p> <p>Clean the filter and empty the Dust Canister.</p> <p>Check for blockages and unblock.</p> <p>Please call 1300 105 888 to order a new Filter or a new Battery.</p>
<p>Charge Fault indicator light flashing</p>	<p>There is a problem with the battery charger.</p> <p>Ensure the Battery Charger is unplugged from the vacuum cleaner and switched off and unplugged from the power point.</p> <p>Please call customer service on 1300 105 888.</p>
<p>Main Fault indicator light flashing</p>	<p>There is a problem with the motor.</p> <p>Ensure the Vacuum Cleaner is switched off then refer to section "7.4" in this manual for further instruction.</p>
<p>Battery Fault indicator light flashing</p>	<p>There is a problem with the battery.</p> <p>Ensure the Vacuum Cleaner is switched off do not charge, then refer to section "7.5" in this manual for further instruction.</p>
<p>Noisy operation</p>	<p>Clean the filter and empty the Dust Canister</p>
	<p>Check for partial blockages and unblock.</p>
<p>Suction Not Strong</p>	<p>Clean the filter and empty the Dust Canister.</p> <p>Check for blockages and unblock.</p> <p>Check that the battery is fully charged.</p> <p>Please call 1300 105 888 to order a new Filter or Battery.</p>
	<p>Speed setting may only be set too Low. Increase Power to select the Highest power mode.</p>
<p>Floor Head hard to push</p>	<p>The Rotary Brush in the floor head may be jammed with debris etc.</p> <p>Ensure the Vacuum Cleaner is switched off, the battery is removed then remove the debris from the brush.</p> <p>Or the carpet pile may be too long and jamming the rotary brush.</p>
<p>Static Shock</p>	<p>In some rare instances, one or two users may feel an electric discharge when touching or using the vacuum cleaner during or after use. This is a well-known phenomenon of Static Electricity discharge that happens mostly when the user vacuums a synthetic fibre carpet or other synthetic surfaces. It can also be more prevalent in dry and cool environments. Although the feeling of Static Electricity can be unpleasant for the user, it is not dangerous and is not a fault of the vacuum cleaner. If this static discharge is a problem for the user, the user could try wearing insulating footwear during vacuuming (i.e., rubber or leather soles) or increase the humidity / heat level in the surrounding environment or both.</p>

12 Warranty Against Defect

12 Month Warranty

Thank you for your purchase.

Your new product is warranted to be free from defects in materials and workmanship for the period stated above, from the date of purchase, provided that the product is used in accordance with accompanying recommendations or instructions where provided. This warranty is in addition to your rights under the Australian Consumer Law. For New Zealand customers, this warranty is in addition to statutory rights observed under New Zealand legislation.

We will provide you with your choice of a refund, repair (where possible) or exchange (availability dependent) for this product if it becomes defective within the warranty period. The business will bear the reasonable expense of claiming the warranty. This warranty will no longer apply where the defect is a result of alteration, accident, misuse, abuse, or neglect.

Please retain your receipt as proof of purchase and contact our Customer Service Centre as listed below, for the entity you purchased this product from, for any difficulties with your product. Warranty claims and claims for expenses incurred in returning this product can be addressed to the respective Customer Service Centre.

Our goods come with guarantees that cannot be excluded under the Australian Consumer Law. You are entitled to a replacement or refund for a major failure and compensation for any other reasonably foreseeable loss or damage. You are also entitled to have the goods repaired or replaced if the goods fail to be of acceptable quality and the failure does not amount to a major failure.

Contact for Kmart purchases	Contact for Target purchases
Kmart Australia Ltd. C/- Customer Service Centre, 690 Springvale Road, Mulgrave Vic 3170 Customer Service: 1800 124 125 (Australia) or 0800 945 995 (New Zealand) or via Customer Help at kmart.com.au	Target Australia Pty Ltd. C/- Customer Service Centre, 2 Kendall Street, Williams Landing, Vic, 3027 Customer Service: 1300 753 567 or via Customer Help at target.com.au/help/contact-us

IMPORTANT! For all technical queries or difficulties in operating the product and for spare parts, contact H.E. Group customer service 1300 105 888 (Australia) and 09 8870 447 (New Zealand).