

**BASIC CROCHET STITCH DIAGRAM**  
**1. Stitch (Abbreviated 'st')**

**Slip knot**  
 Every piece of crochet chain starts with a slip knot. Loop the yarn around two fingers (leaving a tail) and pull the tail halfway through the loop. Insert the crochet hook into the second loop and gently pull the loop taut onto the crochet hook.



**2. Chain Stitch (Abbreviated 'ch')**

The chain stitch is the basis for all crochet which is also called a foundation chain.



**3. Slip Stitch (Abbreviated 'sl st')**

The slip stitch is the flattest or smallest of all crochet stitches. You can use this stitch by slip-stitching the ends of a foundation chain to form a ring.



**4. Single Crochet (Abbreviated 'sc')**

The single crochet is the most fundamental of all stitches. Gather the yarn with your crochet hook and draw up the loop through the stitch. Wrap the yarn around the hook and pull it through two loops, leaving one loop on the hook.

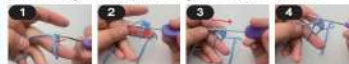

**5. Increase (Abbreviated 'inc')**

You can increase stitches by adding a stitch at the beginning of the row. For example, make 2 sc in the same knot.



**6. Decrease (Abbreviated 'dec')**

You can decrease stitches, which is really just subtracting a stitch, in a row. Make a half sc, at which point there are 2 loops in the hook, then crochet a half sc in the next knot, at which point there are 3 loops in the hook, and finally wind the yarn through all 3 loops to finish a dec.

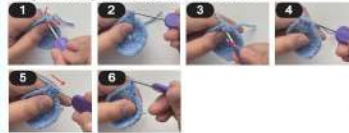

**7. Half Double Crochet (Abbreviated 'hdc')**

Wrap the yarn around the hook, then insert the hook into the next stitch. Wrap the yarn around the hook and pull through all loops.



**8. Magic Ring**

A magic ring is an adjustable starting round used for crochet amigurumi patterns, granny squares and other patterns that work in crochet rounds. Form a loop with your yarn. You will need to loop the yarn around your fingers, insert the hook through the loop. Slide the crochet hook under right piece of yarn from right to left, use the hook tip to grab onto a left yarn, pull the yarn through the ring, make a chain stitch. Put your first row of stitches into the ring. For example, make 6 sc. Pull your yarn ends. Hold the working end of the yarn taut while gently pulling down on the tail end. As you do this, the stitches should close together at the center, completing your magic ring. Finally, slip stitch into the first stitch. To close this round and start the remainder of your pattern, make a slip stitch into the first stitch of your ring, and proceed to the next round.



**9. Insert Your Hook Into 2nd Back Hoop**



**10. Fasten Off (Abbreviated 'F/O')**

Fasten off by pulling the yarn through the end stitch and pulling it taut. Cut off.



**11. Weaving In/Invisible Close**

Cut the yarn, leaving a long yarn end. Draw the end through the final loop on the hook and thread it onto a yarn needle. Weave your needle through the front loops only on the last round and pull tight. Weave remaining yarn into your piece.



Please note that all yarns needs to be hidden behind the stitch.

**12. Sewing**

Generally used for the connection of 2 parts. The plastic needle strap yarns are threaded in turn through the knots where the two parts need to be connected.



If details need to be stitched onto the finished product (such as mouth, eyes, etc), use the plastic needle and thread to create small stitches to represent facial features etc.



**13. Round (Abbreviated 'Rd')**

This continues the chain stitches into a circle. Each round starts with ch and ends with sl st.

**STITCHES USED**

ch	chain	inc-hdc	2 half double crochet in 1 st
sl	slip stitch	sc	single crochet
inc	increase crochet	dec	decrease crochet
hdc	half double crochet	F/O	fasten off

**MAKE A CROCHET PENGUIN**

**1. Body & Head**

- (Please use the blue yarns)  
 R1: 6 sc in magic ring [6 sts]    R2: 6 inc [12 sts]  
 R3: (sc, inc) x 6 times [18 sts]    R4: (2 sc, inc) x 6 times [24 sts]

R5: (3 sc, inc) x 6 times [30 sts]  
 R6: 2 sc, inc, (4 sc, inc) x 5 times, 2 sc [36 sts]  
 R7: (5 sc, inc) x 6 times [42 sts]  
 Please alternate with different colours of yarns for R8-13 (Note: Steps marked in red are white yarns).

R8: 15 sc, 4 sc (with the white yarns), 4 sc (with the gray yarns), 4 sc, 15 sc [42 sts]  
 R9: 14 sc, 6 sc, 2 sc, 6 sc, 14 sc [42 sts]  
 R10-11: 14 sc, 14 sc, 14 sc [42 sts]  
 R12: 15 sc, 12 sc, 15 sc [42 sts]  
 R13: 16 sc, 10 sc, 16 sc [42 sts]

R14: (6 sc, inc) x 6 times [48 sts]  
 R15: 48 sc [54 sts]  
 R16: (7 sc, inc) x 6 times [54 sts]  
 R17-22: 64 sc [54 sts]  
 R23: (7 sc, dec) x 6 times [48 sts]  
 R24: (4 sc, dec) x 8 times [32 sts]  
 R25: (3 sc, dec) x 8 times [24 sts]  
 R26: (2 sc, dec) x 8 times [16 sts]  
 R27: (sc, dec) x 8 times [16 sts]  
 Fill with the fiberfill.  
 R28: 8 dec [8 sts] F/O

**2. Belly**

(Please use the white yarns)  
 R1: 6 sc in magic ring [6 sts]  
 R2: 6 inc [12 sts]  
 R3: (sc, inc) x 6 times [18 sts]  
 R4: (2 sc, inc) x 6 times [24 sts]

R5: (3 sc, inc) x 6 times [30 sts]  
 R6: 2 sc, inc, (4 sc, inc) x 5 times, 2 sc [36 sts]  
 R7: (5 sc, inc) x 6 times [42 sts]  
 R8: 15 sc, 4 sc (with the white yarns), 4 sc (with the gray yarns), 4 sc, 15 sc [42 sts]  
 R9: 14 sc, 6 sc, 2 sc, 6 sc, 14 sc [42 sts]  
 R10-11: 14 sc, 14 sc, 14 sc [42 sts]  
 R12: 15 sc, 12 sc, 15 sc [42 sts]  
 R13: 16 sc, 10 sc, 16 sc [42 sts]

R14: (6 sc, inc) x 6 times [48 sts]  
 R15: 48 sc [54 sts]  
 R16: (7 sc, inc) x 6 times [54 sts]  
 R17-22: 64 sc [54 sts]  
 R23: (7 sc, dec) x 6 times [48 sts]  
 R24: (4 sc, dec) x 8 times [32 sts]  
 R25: (3 sc, dec) x 8 times [24 sts]  
 R26: (2 sc, dec) x 8 times [16 sts]  
 R27: (sc, dec) x 8 times [16 sts]  
 Fill with the fiberfill.  
 R28: 8 dec [8 sts] F/O

R14: (6 sc, inc) x 6 times [48 sts]  
 R15: 48 sc [54 sts]  
 R16: (7 sc, inc) x 6 times [54 sts]  
 R17-22: 64 sc [54 sts]  
 R23: (7 sc, dec) x 6 times [48 sts]  
 R24: (4 sc, dec) x 8 times [32 sts]  
 R25: (3 sc, dec) x 8 times [24 sts]  
 R26: (2 sc, dec) x 8 times [16 sts]  
 R27: (sc, dec) x 8 times [16 sts]  
 Fill with the fiberfill.  
 R28: 8 dec [8 sts] F/O

R14: (6 sc, inc) x 6 times [48 sts]  
 R15: 48 sc [54 sts]  
 R16: (7 sc, inc) x 6 times [54 sts]  
 R17-22: 64 sc [54 sts]  
 R23: (7 sc, dec) x 6 times [48 sts]  
 R24: (4 sc, dec) x 8 times [32 sts]  
 R25: (3 sc, dec) x 8 times [24 sts]  
 R26: (2 sc, dec) x 8 times [16 sts]  
 R27: (sc, dec) x 8 times [16 sts]  
 Fill with the fiberfill.  
 R28: 8 dec [8 sts] F/O

R14: (6 sc, inc) x 6 times [48 sts]  
 R15: 48 sc [54 sts]  
 R16: (7 sc, inc) x 6 times [54 sts]  
 R17-22: 64 sc [54 sts]  
 R23: (7 sc, dec) x 6 times [48 sts]  
 R24: (4 sc, dec) x 8 times [32 sts]  
 R25: (3 sc, dec) x 8 times [24 sts]  
 R26: (2 sc, dec) x 8 times [16 sts]  
 R27: (sc, dec) x 8 times [16 sts]  
 Fill with the fiberfill.  
 R28: 8 dec [8 sts] F/O

R14: (6 sc, inc) x 6 times [48 sts]  
 R15: 48 sc [54 sts]  
 R16: (7 sc, inc) x 6 times [54 sts]  
 R17-22: 64 sc [54 sts]  
 R23: (7 sc, dec) x 6 times [48 sts]  
 R24: (4 sc, dec) x 8 times [32 sts]  
 R25: (3 sc, dec) x 8 times [24 sts]  
 R26: (2 sc, dec) x 8 times [16 sts]  
 R27: (sc, dec) x 8 times [16 sts]  
 Fill with the fiberfill.  
 R28: 8 dec [8 sts] F/O

R14: (6 sc, inc) x 6 times [48 sts]  
 R15: 48 sc [54 sts]  
 R16: (7 sc, inc) x 6 times [54 sts]  
 R17-22: 64 sc [54 sts]  
 R23: (7 sc, dec) x 6 times [48 sts]  
 R24: (4 sc, dec) x 8 times [32 sts]  
 R25: (3 sc, dec) x 8 times [24 sts]  
 R26: (2 sc, dec) x 8 times [16 sts]  
 R27: (sc, dec) x 8 times [16 sts]  
 Fill with the fiberfill.  
 R28: 8 dec [8 sts] F/O

R14: (6 sc, inc) x 6 times [48 sts]  
 R15: 48 sc [54 sts]  
 R16: (7 sc, inc) x 6 times [54 sts]  
 R17-22: 64 sc [54 sts]  
 R23: (7 sc, dec) x 6 times [48 sts]  
 R24: (4 sc, dec) x 8 times [32 sts]  
 R25: (3 sc, dec) x 8 times [24 sts]  
 R26: (2 sc, dec) x 8 times [16 sts]  
 R27: (sc, dec) x 8 times [16 sts]  
 Fill with the fiberfill.  
 R28: 8 dec [8 sts] F/O

R14: (6 sc, inc) x 6 times [48 sts]  
 R15: 48 sc [54 sts]  
 R16: (7 sc, inc) x 6 times [54 sts]  
 R17-22: 64 sc [54 sts]  
 R23: (7 sc, dec) x 6 times [48 sts]  
 R24: (4 sc, dec) x 8 times [32 sts]  
 R25: (3 sc, dec) x 8 times [24 sts]  
 R26: (2 sc, dec) x 8 times [16 sts]  
 R27: (sc, dec) x 8 times [16 sts]  
 Fill with the fiberfill.  
 R28: 8 dec [8 sts] F/O

R14: (6 sc, inc) x 6 times [48 sts]  
 R15: 48 sc [54 sts]  
 R16: (7 sc, inc) x 6 times [54 sts]  
 R17-22: 64 sc [54 sts]  
 R23: (7 sc, dec) x 6 times [48 sts]  
 R24: (4 sc, dec) x 8 times [32 sts]  
 R25: (3 sc, dec) x 8 times [24 sts]  
 R26: (2 sc, dec) x 8 times [16 sts]  
 R27: (sc, dec) x 8 times [16 sts]  
 Fill with the fiberfill.  
 R28: 8 dec [8 sts] F/O

R14: (6 sc, inc) x 6 times [48 sts]  
 R15: 48 sc [54 sts]  
 R16: (7 sc, inc) x 6 times [54 sts]  
 R17-22: 64 sc [54 sts]  
 R23: (7 sc, dec) x 6 times [48 sts]  
 R24: (4 sc, dec) x 8 times [32 sts]  
 R25: (3 sc, dec) x 8 times [24 sts]  
 R26: (2 sc, dec) x 8 times [16 sts]  
 R27: (sc, dec) x 8 times [16 sts]  
 Fill with the fiberfill.  
 R28: 8 dec [8 sts] F/O

R14: (6 sc, inc) x 6 times [48 sts]  
 R15: 48 sc [54 sts]  
 R16: (7 sc, inc) x 6 times [54 sts]  
 R17-22: 64 sc [54 sts]  
 R23: (7 sc, dec) x 6 times [48 sts]  
 R24: (4 sc, dec) x 8 times [32 sts]  
 R25: (3 sc, dec) x 8 times [24 sts]  
 R26: (2 sc, dec) x 8 times [16 sts]  
 R27: (sc, dec) x 8 times [16 sts]  
 Fill with the fiberfill.  
 R28: 8 dec [8 sts] F/O

R14: (6 sc, inc) x 6 times [48 sts]  
 R15: 48 sc [54 sts]  
 R16: (7 sc, inc) x 6 times [54 sts]  
 R17-22: 64 sc [54 sts]  
 R23: (7 sc, dec) x 6 times [48 sts]  
 R24: (4 sc, dec) x 8 times [32 sts]  
 R25: (3 sc, dec) x 8 times [24 sts]  
 R26: (2 sc, dec) x 8 times [16 sts]  
 R27: (sc, dec) x 8 times [16 sts]  
 Fill with the fiberfill.  
 R28: 8 dec [8 sts] F/O

R14: (6 sc, inc) x 6 times [48 sts]  
 R15: 48 sc [54 sts]  
 R16: (7 sc, inc) x 6 times [54 sts]  
 R17-22: 64 sc [54 sts]  
 R23: (7 sc, dec) x 6 times [48 sts]  
 R24: (4 sc, dec) x 8 times [32 sts]  
 R25: (3 sc, dec) x 8 times [24 sts]  
 R26: (2 sc, dec) x 8 times [16 sts]  
 R27: (sc, dec) x 8 times [16 sts]  
 Fill with the fiberfill.  
 R28: 8 dec [8 sts] F/O

R14: (6 sc, inc) x 6 times [48 sts]  
 R15: 48 sc [54 sts]  
 R16: (7 sc, inc) x 6 times [54 sts]  
 R17-22: 64 sc [54 sts]  
 R23: (7 sc, dec) x 6 times [48 sts]  
 R24: (4 sc, dec) x 8 times [32 sts]  
 R25: (3 sc, dec) x 8 times [24 sts]  
 R26: (2 sc, dec) x 8 times [16 sts]  
 R27: (sc, dec) x 8 times [16 sts]  
 Fill with the fiberfill.  
 R28: 8 dec [8 sts] F/O

R14: (6 sc, inc) x 6 times [48 sts]  
 R15: 48 sc [54 sts]  
 R16: (7 sc, inc) x 6 times [54 sts]  
 R17-22: 64 sc [54 sts]  
 R23: (7 sc, dec) x 6 times [48 sts]  
 R24: (4 sc, dec) x 8 times [32 sts]  
 R25: (3 sc, dec) x 8 times [24 sts]  
 R26: (2 sc, dec) x 8 times [16 sts]  
 R27: (sc, dec) x 8 times [16 sts]  
 Fill with the fiberfill.  
 R28: 8 dec [8 sts] F/O

R14: (6 sc, inc) x 6 times [48 sts]  
 R15: 48 sc [54 sts]  
 R16: (7 sc, inc) x 6 times [54 sts]  
 R17-22: 64 sc [54 sts]  
 R23: (7 sc, dec) x 6 times [48 sts]  
 R24: (4 sc, dec) x 8 times [32 sts]  
 R25: (3 sc, dec) x 8 times [24 sts]  
 R26: (2 sc, dec) x 8 times [16 sts]  
 R27: (sc, dec) x 8 times [16 sts]  
 Fill with the fiberfill.  
 R28: 8 dec [8 sts] F/O

R14: (6 sc, inc) x 6 times [48 sts]  
 R15: 48 sc [54 sts]  
 R16: (7 sc, inc) x 6 times [54 sts]  
 R17-22: 64 sc [54 sts]  
 R23: (7 sc, dec) x 6 times [48 sts]  
 R24: (4 sc, dec) x 8 times [32 sts]  
 R25: (3 sc, dec) x 8 times [24 sts]  
 R26: (2 sc, dec) x 8 times [16 sts]  
 R27: (sc, dec) x 8 times [16 sts]  
 Fill with the fiberfill.  
 R28: 8 dec [8 sts] F/O

R14: (6 sc, inc) x 6 times [48 sts]  
 R15: 48 sc [54 sts]  
 R16: (7 sc, inc) x 6 times [54 sts]  
 R17-22: 64 sc [54 sts]  
 R23: (7 sc, dec) x 6 times [48 sts]  
 R24: (4 sc, dec) x 8 times [32 sts]  
 R25: (3 sc, dec) x 8 times [24 sts]  
 R26: (2 sc, dec) x 8 times [16 sts]  
 R27: (sc, dec) x 8 times [16 sts]  
 Fill with the fiberfill.  
 R28: 8 dec [8 sts] F/O

R14: (6 sc, inc) x 6 times [48 sts]  
 R15: 48 sc [54 sts]  
 R16: (7 sc, inc) x 6 times [54 sts]  
 R17-22: 64 sc [54 sts]  
 R23: (7 sc, dec) x 6 times [48 sts]  
 R24: (4 sc, dec) x 8 times [32 sts]  
 R25: (3 sc, dec) x 8 times [24 sts]  
 R26: (2 sc, dec) x 8 times [16 sts]  
 R27: (sc, dec) x 8 times [16 sts]  
 Fill with the fiberfill.  
 R28: 8 dec [8 sts] F/O

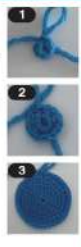

**3. Feet x 2**

(Please use the blue yarns)  
 R1: 6 sc [6 sts]  
 R2: (inc, 2 sc) x 2 times [8 sts]  
 R3: 8 sc [8 sts]  
 Make 4 sc in aligned knots at the opening to seal, F/O.

**4. Wings x 2**

(Please use the blue yarns)  
 R1: with gray yarn, 6 sc [6 sts]  
 R2: (inc, 2 sc) x 2 [8 sts]  
 R3: (sc, inc) x 4 [12 sts]  
 R4: 12 sc [12 sts]  
 R5: (2 sc, dec) x 3 [9 sts]  
 Make 4 sc in aligned knots at the opening to seal, F/O.

**5. Sewing all the parts**

1. Use the plastic needle to sew the belly onto the body then the feet and wings. (Fig. 1-2) Once finished, hide the excess threads inside the body.  
 2. Please use the black yarns to sew an "X" on both sides of R11 of the body as the penguin's eyes and use the orange yarns to sew a horizontal "I" at the middle of R12 as the penguin's mouth. (Fig. 3-4)



MADE IN CHINA

CUSTOMER SERVICE:  
 KNAART AU: 1800 124 125  
 KNAART NZ: 0800 945 945  
 TARGET AU: 1800 753 567

K: 43-494-330  
 T: 79-293-456

**anko**

**Mini Crochet Kit Penguin 14+**  
 Instruction Manual

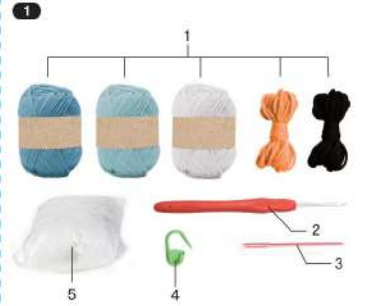

**WHAT'S IN THE BOX**

1. Crochet yarn x 5
2. Crochet hook x 1
3. Plastic needle x 1
4. Ring stitch marker x 1
5. 10g fiberfill x 1