

anko

Bluetooth® Gaming Controller Instruction Manual

K: 43499748 | T: 70363609 (Model: JLR-79884-P)

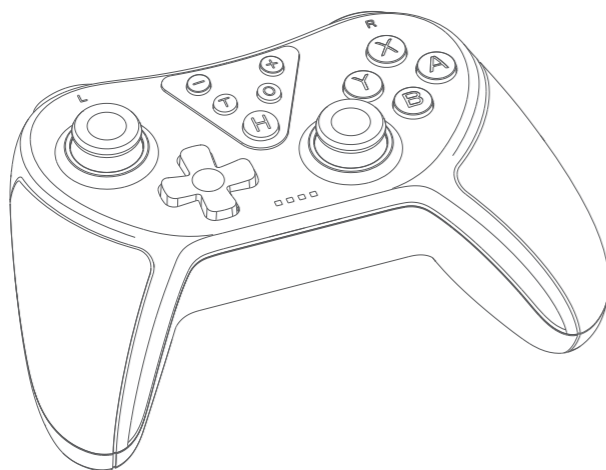

Cautions

1. Before use, please read this manual carefully, be familiar with the operation and adjustment.
2. Products cannot be disassembled privately.
3. Products are strictly prohibited in the fire, water, lest appear explosion.
This gaming controller is for Switch/Switch Lite/Switch OLED, and suporting PC x-input/steam (part of the native support handle games) ONLY.

Product Overview

The bluetooth gamepad is a high-quality wireless game handle with TURBO and good auxiliary functions, which makes your experience more accurate and true. Simple Usage and Comfortable Appearance The fully functional and ergonomic design of this handle ensures precision, stability and comfort of use.

Button Instructions

This game controller is composed by 19 function buttons (upper, lower, left, right, A, B, X, Y, L,ZL,R,ZR,L3,R3, -, +, TURBO, Home,Screen capture) and 2 simulated 3D joysticks.

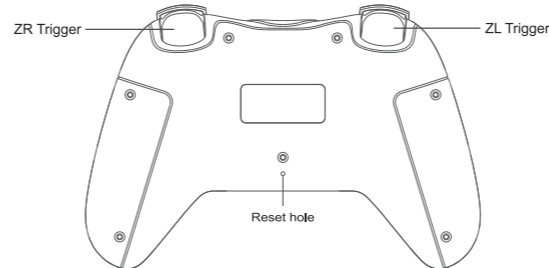
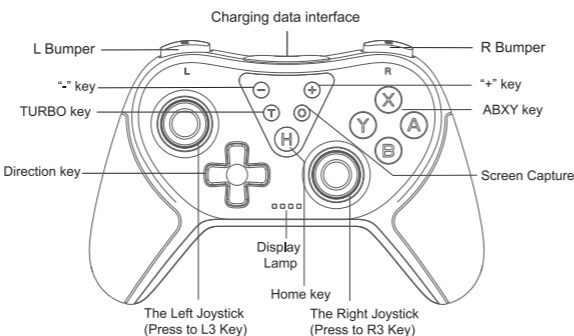

Product Specifications

Input voltage: DC 5V 300mA Battery capacity: 400mAh
Charging time: 2-3h Cable Length: 1m

Pairing and Connecting

- The host pairing operation of Switch/Switch Lite/Switch Oled:
 1. Open the host, click the settings button to close the airplane mode, open the wireless switch.
 2. Into the host wireless pairing mode, click the controllers button on the home page to change the grip/order.
 3. Press and hold the HOME button for 3 seconds until the handle channel light LED1-4 running display (LED1-LED4-LED1) changes from slow to fast and enters wireless pairing mode.

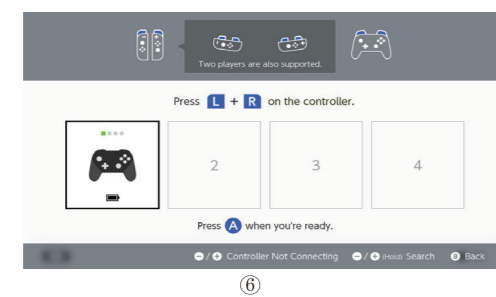
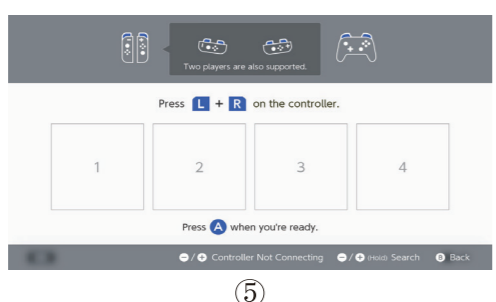
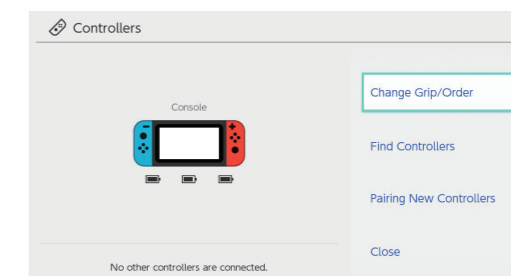
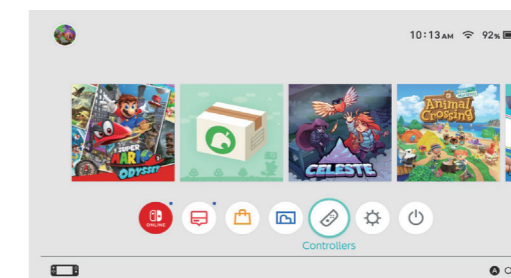
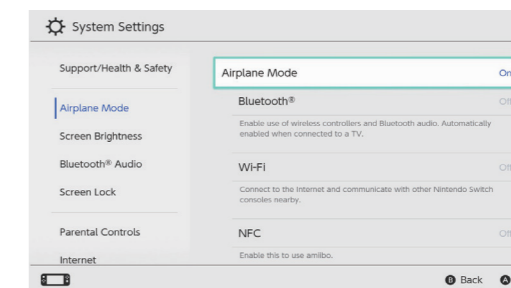
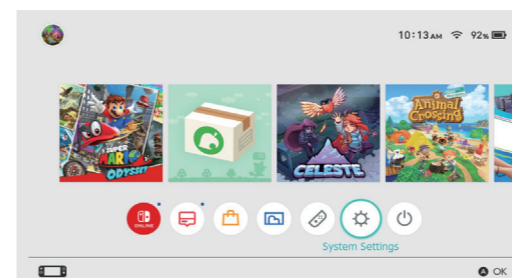

- Connection Back Mode: Handle and the host has been connected once to be remembered, the host in the power-on state, can be pressed in seconds.
- HOME button handle light up will automatically connect to the host, that is, a key back to connect.

PC Connection Mode

- This handle supports Windows x-input class computer games.
- Wired connection:
 - PC X-input corresponding to the part of the game can be operated by the wired handle's connection to PC by USB.
 - 1. Connect to PC at the 'Off' condition
 - 2. Press and hold down the "-" and "+" keys at the same time for 3 seconds to switch to the X-input mode. LED2 will turn on and save the Setting.
 - 3. LED 2 light on in PC X-input mode, always on when fully charged, LED blinking in charging status), Windows will automatically install the driver.

- Steam platform:
 - After connecting to PC, open Steam, automatically recognized to steam mode, LED1 light on.

TURBO Function

- The first time, press and hold the button you need to set the burst and then press TURBO, it will be a semi-automatic burst, the second operation will enter the fully automatic burst function, and the third operation will cancel the burst.
- Turbo key assignable function of the key: A, B, X, Y, L,ZL,R,ZR.
- Adjust the burst speed:
 1. When holding down the Turbo key and pushing the right stick up, change the burst speed in the following order:
5 times per second→12 times per second →20 times per second
 2. When holding down the Turbo key and pushing the right stick down, change the burst speed in the following order:
20 times per second →12 times per second→5 times per second
- The default initial speed is 12 times per second.

Motor Vibration Function

- A total of 4 vibration intensity: 100%, 70%, 30%, 0%, open, close or adjust the file number manually. The default initialization file is 100%:
1. When holding down the Turbo key and pushing the left stick up, the intensity is increased by one step.
 2. When holding down the Turbo key and pushing the left stick down, the intensity is reduced by one step.

How to reset

If your controller is not paired, does not respond, or shows a flashing light, you need to reset the handle. Only need a tool like the pin for retrieving card, press the reset button on the built-in, the handle will reset to factory settings.

Reverse Side of the Handle:

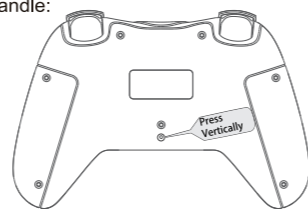

Power off/Charging/Alarm for low battery

Status	Description
Power off	To shut down the controller, please press HOME button for 5 seconds, until the indicator light to go out. When the controller is in a state of pairing, if failed to connect more than 60 seconds, it will automatically shut down, but don't sleep for automatic TURBO activity. When the controller is connected to the host, if more than five minutes without action, the handle will be closed and into the sleep mode.
Charging	When the controller is not connected to the host, the LED indicator flashes when the controller is charging; when it is full, the indicator goes off. In the case of connected host, the LED indicator of the currently connected mode channel flashes when the handle is charging; when it is full, the indicator goes out.
Alarm for low battery	When the LED1 indicator keeps shining, which shows that the handle is about to run out of power and needs to charge.

Six Axis Calibration

Decreasing Key +HOME:
Under the dormancy condition, firstly press the minus key and remains still, and press the HOME into calibration (The handle indicator flashes left and right). Put the controller in a horizontal position, then press the '+' button and release it to start the handle calibration. The controller starts to calibrate. When calibration is complete, all 4 LEDs light up for about 3 seconds and automatically go to sleep.

Package

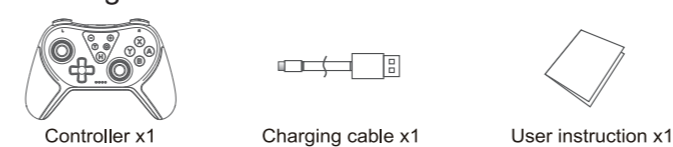

12 Month Warranty

Thank you for your purchase.

Your new product is warrantied to be free from defects in materials and workmanship for the period stated above, from the date of purchase, provided that the product is used in accordance with accompanying recommendations or instructions where provided. This warranty is in addition to your rights under the Australian Consumer Law.
For New Zealand customers, this warranty is in addition to statutory rights observed under New Zealand legislation.

We will provide you with your choice of a refund, repair (where possible) or exchange (availability dependent) for this product if it becomes defective within the warranty period. The business will bear the reasonable expense of claiming the warranty.
This warranty will no longer apply where the defect is a result of alteration, accident, misuse, abuse or neglect.

Please retain your receipt as proof of purchase and contact our Customer Service Centre as listed below, for the entity you purchased this product from, for any difficulties with your product. Warranty claims and claims for expense incurred in returning this product can be addressed to the respective Customer Service Centre.

Our goods come with guarantees that cannot be excluded under the Australian Consumer Law. You are entitled to a replacement or refund for a major failure and compensation for any other reasonably foreseeable loss or damage. You are also entitled to have the goods repaired or replaced if the goods fail to be of acceptable quality and the failure does not amount to a major failure.

Contact for Kmart purchases	Contact for Target purchases
Kmart Australia Ltd. C/- Customer Service Centre 690 Springvale Road, Mulgrave Vic 3170 Customer Service: 1800 124 125 (Australia) or 0800 945 995 (New Zealand) or via Customer Help at kmart.com.au	Target Australia Pty Ltd C/- Customer Service Centre 2 Kendall Street, Williams Landing, Vic, 3027 Customer Service: 1300 753 567 or via Customer Help at target.com.au/help/contact-us