

anko

Wet and Dry Vacuum Cleaner For Household Use Only



Model No.: YLW6364-20L

Rev 1

Note: The specifications and/or components of this appliance are subject to change without prior notice.

If the Hose, Floor Head, or any Accessories should fail during use, please call customer service for an immediate replacement. This will save you from returning the product to the store.

If we can assist you in any other way, please feel free to contact us.

1	Warnings	4
2	Safety Direction	4
3	Transporting your Vacuum	6
4	Components	7
5	Side Clamps	8
6	Castor Wheels Assembly	8
7	Fitting Flexible Hose	9
	7.1 Vacuum Function.....	9
	7.2 Blower Function.....	10
	7.3 Floor Head Inserts	10
	7.4 Tubes and Accessories	12
	7.5 Crevice / Brush Tool	12
8	Power and Power Cord	13
	8.1 Power Cord Storage	13
9	Suction Relief Slide	13
10	Operation	14
	10.1 Using as a Dry Vacuum Cleaner	14
	10.2 Using as a Wet Vacuum Cleaner.....	14
11	Safety Devices Operation	16
12	Emptying the Dust Canister	16
13	User Maintenance	17
	13.1 Cleaning Filters.....	17
	13.1.1 Black Foam Filter.....	18
	13.1.2 Large Dust Canister Filter	19
	13.2 Cleaning the Vacuum Cleaner Body and Tools	19
14	Storage	19
15	Troubleshooting	21
16	Warranty Against Defect	23

1 Warnings

Before using this appliance, read and follow all warnings and instructions in this manual, even if you are familiar with this product.

This appliance is not intended for use by persons (including children) with reduced physical, sensory, or mental capabilities, or lack of experience and knowledge, unless they have been given supervision or instruction concerning use of the appliance by a person responsible for their safety.

Children should be supervised to ensure that they do not play with the appliance.

IMPORTANT: This Product can be used for vacuuming up small liquid spills only. It is NOT designed to be used as a pump to empty water containers, pits, sinks, or the like.

2 Safety Direction



Please read this instruction manual carefully before first use. It is advisable to keep this instruction manual for future reference.

DO NOT vacuum, flammable liquids, ashes, hot coals, cigarette butts, matches or any hot, smoking or burning objects, etc.

Never expose the appliance to rain or submerge in water.

DO NOT pick up flammable or combustible materials (i.e., lighter fluid, petrol, kerosene, etc.) or use in the presence of explosive liquids or vapour.

DO NOT pick up toxic material (i.e., chlorine bleach, ammonia, drain cleaner, etc.)

DO NOT vacuum Toner (for laser printer, copy machines etc.) as there is a risk of fire and explosion.

DO NOT vacuum plaster, cement etc. as the filter can become blocked.

DO NOT use the vacuum without all the filters fitted.

DO NOT store or use the appliance near high temperature areas.

DO NOT run over the power cord with the vacuum cleaner.

DO NOT use the vacuum cleaner if it is blocked. Turn off and clear all blockages before continuing.

DO NOT use the vacuum cleaner with blocked filters. Clean filters before continuing. (refer to User Maintenance section).

DO NOT use the vacuum cleaner if the appliance malfunctions, abnormal noise, smell, smoke, is dropped or damaged in any manner or any breakage is found during operation.

For electrical safety, any repairs to the product must be performed by a qualified electrical person only, or the product must be disposed of.

DO NOT misuse the cord. Never pull the appliance by the cord or pull to disconnect it from the outlet. Instead, grasp the plug and pull to disconnect.

DO NOT use the vacuum cleaner to pick up large objects, hard or sharp objects such as glass, nails, screws, coins, etc. that are likely to cause damage.

DO NOT use vacuum cleaner if it has been dropped, damaged, left outdoors, or dropped into liquid (water etc.)

DO NOT close door on cord or pull cord around sharp edges or corners.

DO NOT handle plug or vacuum cleaner with wet hands.

DO NOT put any objects into openings.

DO NOT use with any openings blocked and do not restrict airflow.

DO NOT operate the appliance with a damaged cord or plug.

If the supply cord is damaged, it must be replaced by the manufacturer, its service agent, or similarly qualified persons in order to avoid a hazard.

DO NOT use without filters in place.

DO NOT attempt to modify this product in any way.

DO empty the Dust Canister regularly for optimal operation of the vacuum.

DO keep hair, loose clothing, fingers, feet, and body parts away from openings or moving parts.

DO disconnect the appliance from the mains supply before connecting the flexible suction hose.

DO turn off controls before you connect or disconnect the appliance to or from the mains supply.

DO disconnect the appliance from the power supply when not in use, before changing the dust filter, cleaning the filters, or connecting / disconnecting the accessories.

DO use only as described in this manual. Use only manufacturer's recommended attachments.

DO Keep cord away from heated surfaces.

DO Keep all openings free of dust, lint, hair, and anything that may reduce airflow.

DO use extra care when vacuuming on stairs.

DO keep your work area well lit.

DO store your appliance indoors in a cool, dry area.

DO ensure children and babies cannot play with plastic bags or any packaging materials.

DO operate the appliance from a power source of the same voltage, frequency and rating as indicated on the product identification plate.

If a third party uses this appliance, **DO** supply the instruction manual with it.

No liability can be accepted for any damage caused by non-compliance with these instructions or any other improper use or mishandling of appliance.

This product has not been designed for any uses other than those specified in this manual.

ONLY for domestic use. Industrial or commercial use invalidates the warranty.

Please note: It is especially important that the filters, dust canister and components are kept clean and free from blockages, etc.

Failure to keep clean and well maintained will reduce the performance of your vacuum cleaner and may cause the motor to overheat.

Please refer to the “User Maintenance” Section for further instruction on cleaning.

Read and Save These Instructions

3 Transporting your Vacuum

To move your vacuum cleaner from room to room, unplug the unit and carry using the carry handle only.

Never pull or carry the vacuum cleaner by its power cord.

Never carry the vacuum cleaner by the flexible hose.

4 Components

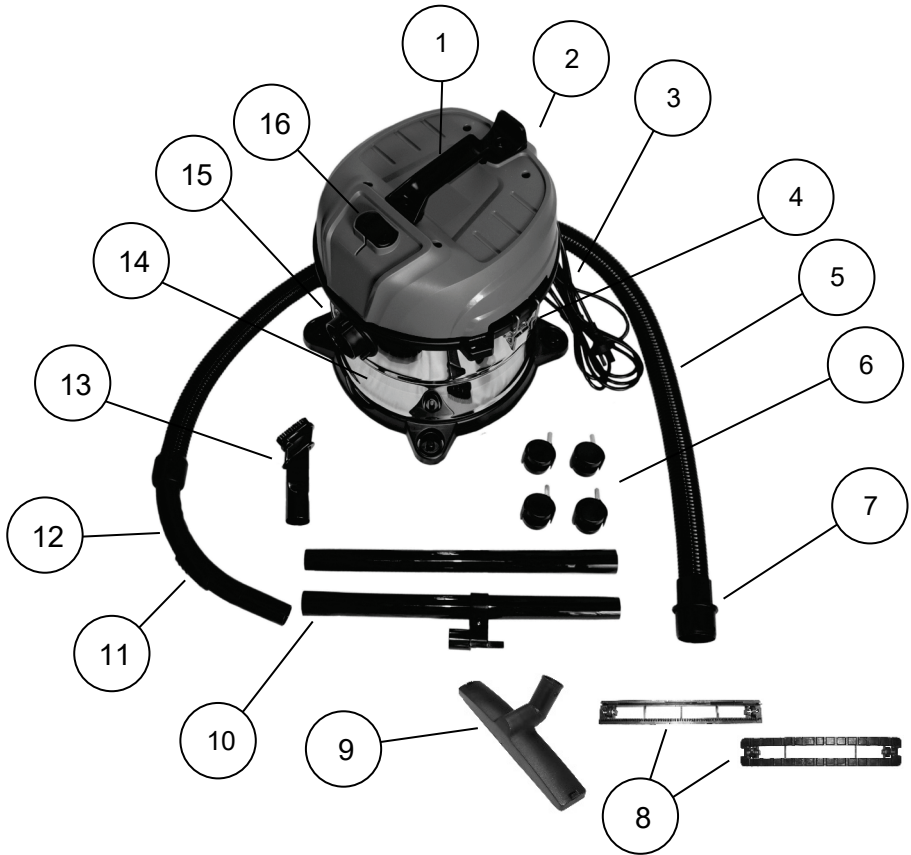

1	Carry Handle	9	Floor Head
2	Air Outlet / Hose Connection (at rear)	10	Extension Tubes x 2
3	Power Cord	11	Suction Relieve Valve
4	Side Clamp x 2	12	Hose Handle
5	Hose	13	Crevice / Brush Tool
6	Castor Wheels	14	Dust Canister
7	Hose Coupling	15	Suction Inlet / Hose Connection
8	Hard Floor and Carpet Inserts for Floor Head	16	Power On – Off Button

Note: The specifications and/or components of this appliance are subject to change without prior notice

5 Side Clamps

To remove the Upper Motor Housing from the Lower Dust Canister, the two side clamps need to be unlatched and lifted away from the clamping blocks.

To do this, grasp the lower section of the clamp lever and lift outward and up then drop down as shown.

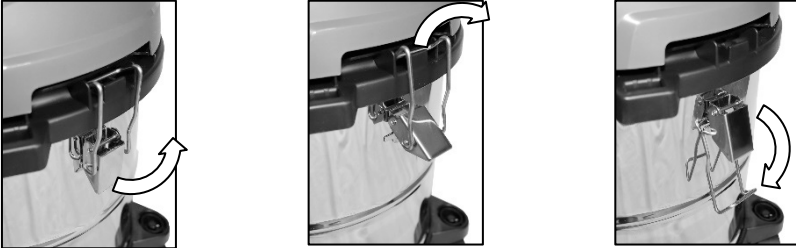

To re-clamp, lift and place the clamp back on the clamp blocks, and then push the clamp lever inward to the vacuum cleaner body until it snaps closed.

6 Castor Wheels Assembly

To save space and waste on packaging, the castor wheels have been supplied unassembled.

These need to be fitted to the bottom of the vacuum cleaner before use. To do this, follow the next steps.

The castor wheels are placed inside the Dust Canister, so to gain access to them, remove the Motor Housing from the Dust Canister by first unlatching the two side latches as described under the section “Side latches” and lifting the motor housing away.

Remove the large filter from the dust canister to find the castor wheels in the bottom of the dust canister.

Turn the dust canister upside down and place of a firm hard surface.



Take one of the castor wheels and align the metal pin up with one of the holes in the base surround as shown then push down hard until the metal pin is fully inserted.

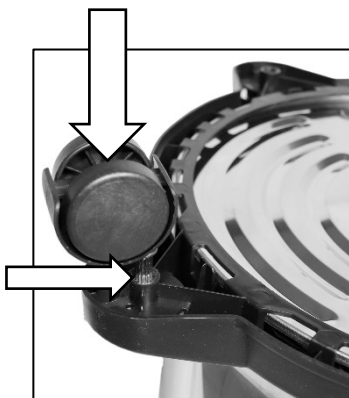

Repeat for the other three castor wheels and then turn the duct canister back over.



7 Fitting Flexible Hose

7.1 Vacuum Function

Fully insert the coupling end of the vacuum cleaner hose into the Vacuum Connector hole, align the tabs with the slots, push in hard and rotate clockwise until it locks into place.



To remove the flexible hose from the vacuum cleaner, rotate the hose coupling anticlockwise to unlatch, and then pull the coupling straight out.

7.2 Blower Function

This can be used for lightly blowing debris off a work bench etc.

NOTE: This is not an Air Compressor so should not be used as such.

Fully insert the coupling end of the vacuum cleaner hose into the Blower Connector hole on the opposite side to the Vacuum Connector Hole. Align the tabs with the slots, push in hard and rotate clockwise until it locks into place.

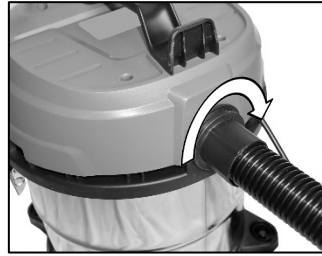
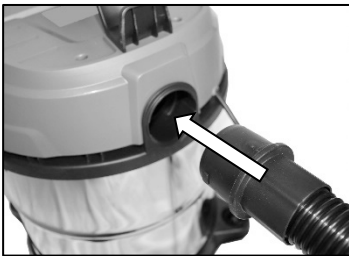

To remove the flexible hose from the vacuum cleaner, rotate the hose coupling anticlockwise to unlatch, and then pull the coupling straight out.

7.3 Floor Head Inserts

Depending on what floor surface you wish to vacuum, there are two inserts to choose from.

There is an insert with a row of bristles and a rubber squeegee which is for vacuuming hard floors, and another insert without bristles or rubber squeegee for use on carpeted surfaces.



To change the insert, first remove the current insert from the floor head by pushing the side clips inward one end at a time, and at the same time, push the clips down to push them out of the floor head as shown.



If required, to assist easier removal of the inserts, hook your finger around one of the crossbars, and whilst pushing one of the side clips across, pull in the insert to lever it out off the floor head as shown.

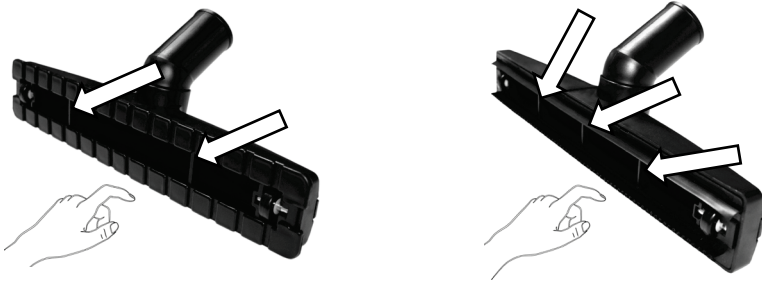

To fit the other insert, align the clips with the slots in the floor head and push the insert all the way in until the insert locks in place.



Note: When fitting the Hard Floor Insert that has the bristles and rubber squeegee, the bristles must face to the front of the floor head.



For the Carpet insert, this can be fitted in either orientation.



7.4 Tubes and Accessories

Take the two straight tubes and insert the small end of the tube without the tool holder attached into the larger end of the tube with the tool holder attached.



Insert the hose handle into the upper large end of the tube.

Insert the lower smaller end of the tube into the Floor Head.



7.5 Crevice / Brush Tool

The Crevice / Brush tool is for cleaning furniture and into corners etc.

To use the Brush Tool, clip the brush section onto the end of the Crevice tool.



To use the Crevice tool, pull the Brush section off the front of the Crevice tool.



8 Power and Power Cord

- Before using the appliance, ensure the power cord is fully unwound.
- Plug into the power point and switch on.
- Press the (I) On button to start the motor.
- Press the (O) Off button to Turn Off

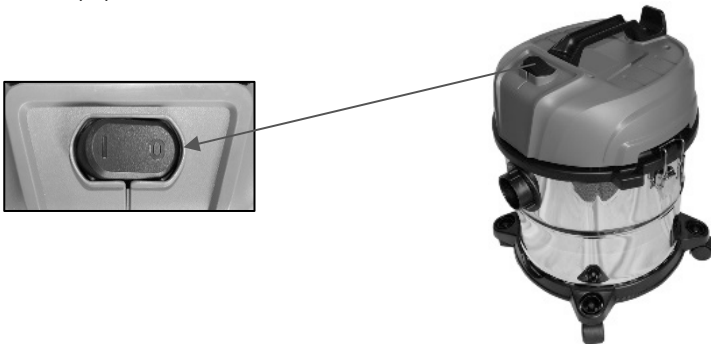

8.1 Power Cord Storage

To Store the power cord, loosely wind the cord around the top section of the vacuum cleaner.

9 Suction Relief Slide

The Suction Relief Valve in the Hose Handle is used for easy, temporary reduction of the vacuum cleaner suction at the floor head.

Slide the Suction Control Slide to the open position to reduce the suction power and then slide close to revert back to full suction power at the floor head.



10 Operation

10.1 Using as a Dry Vacuum Cleaner

When using to vacuum up dry debris, both the black foam filter and the large canister filter needs to be fitted.



10.2 Using as a Wet Vacuum Cleaner

When using to vacuum up liquids, only the black foam filter must be fitted.

The large canister filter **must be** removed.



IMPORTANT: This Product can be used for vacuuming up **small liquid spills only.**

It is **NOT** designed to be used as a pump to empty water containers, pits, sinks, or the like.

The Float Post has a small float inside. (image on the right shown without the black filter fitted for clarity). Never use without the black filter fitted.

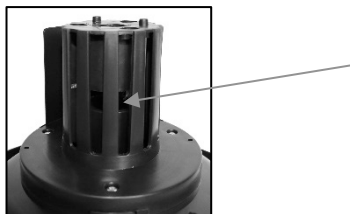

This float is designed to rise up with the water level inside the dust canister and will block off the air inlet into the suction impeller.

This is a device to help prevent water being sucked up into the impeller and being ejected out of the Air Exhaust Port.

Depending on the level of water inside the dust canister, it is possible that a fine mist will be ejected from the Air Outlet Port.

If you notice the mist or the motor beginning to strain, immediately turn the motor off and empty the dust canister.

Also, should the vacuum cleaner be placed on a steep angle or even tip over during use, the float will be sucked up and will block off the air inlet reducing the suction.

To allow the float to reset, turn the motor off and stand the vacuum cleaner on its wheels again, on a horizontal flat surface.

When the motor stops, the float will drop down.

VERY IMPORTANT: After each use when vacuuming up small liquid spills, it is crucial that the black filter be washed and fully dried before using again.

This is to prevent any dust turning into “mud” and setting hard which will block the filter.

11 Safety Devices Operation

NOTE: The motor has an overheating protection device built in.

It will automatically switch off power to the motor if it overheats. e.g., from blocked nozzles, a full Dust Canister, or uncleaned and blocked filters.

If this happens, turn off the vacuum cleaner and unplug from the power socket, clean blockage and / or filters and allow to rest for at least 60 minutes which should be enough time for the motor to cool down.

Important: If the over-temperature device activates and turns the motor off, and you do not switch off and unplug the appliance from the power point, the motor will restart automatically after it has cooled down enough to reset the safety device.

NOTE: NEVER BLOCK ANY VENTS OR OPENINGS and KEEP FILTERS CLEAN.

12 Emptying the Dust Canister

Empty the Dust Canister as frequently as possible or when the suction power is reduced.

Turn off the power and unplug from the power point first.

- Remove the Flexible Hose.
- To remove the Dust Canister from the top Motor Housing, unlatch the two side latches as described previously in the section “Side Latches” then lift the Motor Housing up and away from the lower dust canister.
- Take the dust canister to a dustbin, remove the large filter, and tip out the contents.
- Tap the large filter on the side of the rubbish bin to dislodge and dust and debris.
- Brush the inside of the dust canister with a small brush or wash. Refer to section “Cleaning”.
- Refit the large filter back into the dust canister.
- To refit the Motor Housing to the Dust Canister, place the motor housing back on the dust canister and align the side clamps.

- Lift and place the clamp back on the clamp blocks, and then push the clamp lever inward to the vacuum cleaner body until it snaps closed.

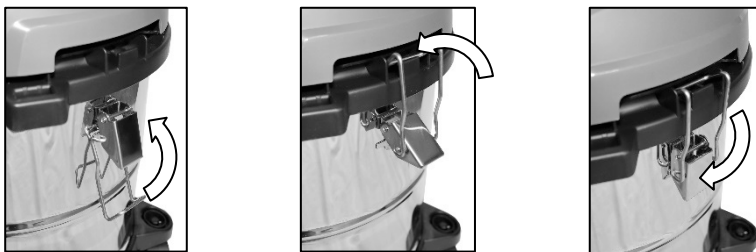

NOTE: It is important that the Clamp Blocks on the side of the motor housing are properly aligned with the Clamps so as to prevent excessive stress on the clamps.

13 User Maintenance

WARNING: The plug must be removed from the power point before any maintenance, cleaning, or replacement of parts.

NOTE: To maximise the performance of your vacuum cleaner, you should clean your filters regularly.

If the filters are broken or worn, replace them before continuing to use the vacuum.

13.1 Cleaning Filters

Important Note – the Filters must be cleaned regularly for best suction performance and to prevent over-heating and damage to your vacuum cleaner.

If you have used the vacuum cleaner to vacuum up small liquid spills, it is crucial that the Black Foam filter be washed and fully dried before using again.

This is to prevent any dust turning into “mud” and setting hard which will block the filter.

Cleaning is best done at the same time when emptying the dust Canister after you have finish vacuuming for the day.

NOTE: Never use the vacuum cleaner without both filters fitted for dry vacuuming, or only the Black Filter fitted when vacuuming small liquid spills.

13.1.1 Black Foam Filter

To remove the Black Foam Filter, remove the top motor housing from the dust canister as described previously.

Flip the motor housing over so that it is upside down.



Rotate the locking plate anticlockwise to unlock and lift up to remove.



Remove the Black Foam Filter by sliding it off the centre post.

Wash the black foam filter in warm mild soapy water, rinse in clean fresh cold water and let completely dry.

DO NOT scrub the filter or place it in a dishwasher.

DO NOT use a hair dryer to dry the filter.

It is recommended to clean this filter every 3 months or sooner if required, and after every use when vacuuming up small liquid spills.

Refit to the Motor Housing in reverse order ensuring the locking plate is firmly locked in place.

13.1.2 Large Dust Canister Filter

To clean the large dust canister filter, remove it from the top of the dust canister and just tap the edge of the filter on a hard surface to dislodge any dust and remove any large debris.

Wash the large filter in warm mild soapy water, rinse in clean fresh cold water and let completely dry. **NOTE:** Only wash if really necessary.

DO NOT scrub the filter or place it in a dishwasher.

DO NOT use a hair dryer to dry the filter.

Refit the large filter to the dust canister or replace with a new one if required.

13.2 Cleaning the Vacuum Cleaner Body and Tools

Do Not clean the vacuum cleaner, components or accessories using petrol or any other flammable liquid or solvents, etc.

Clean the vacuum cleaner motor housing (Top Section), components and accessories using only a moist cloth and mild detergent.

The Dust Canister can be washed inside and out but must be fully dry before re-assembling the filters and top Motor Housing section.

After cleaning, wipe off the moisture on the vacuum cleaner, components, and accessories with a dry cloth.

Do Not place accessories and components in a dishwasher.

Never expose the appliance to rain or submerge in water.

14 Storage

When finished using the vacuum cleaner, loosely wind the power cord around the vacuum cleaner body as described in the section "Power Cord Storage" and store away in a dry cool place.

Never store the appliance outdoors.

The Assembled Extension tubes with the attached floor head can be stored on the side of the vacuum cleaner by using the hanging hook as shown.



The Crevice / Brush Tool can be stored on the tool holder located on the extension tube as shown.



15 Troubleshooting

Noisy operation	Clean the Filters and empty the Dust Canister
	Check for partial blockages and unblock.
Weak Suction	Clean the Filters and empty the Dust Canister.
	Check for blockages and unblock.
	Check that the Suction Relief Valve on the hose handle is closed.
Over-heating / Stopping	Clean the Filters, empty the Dust Canister, check for blockages, and unblock, then allow it to cool for up to hour before trying to restart.
Floor Brush hard to push on carpet	You may have the Hard Floor Insert Fitted. If so, swap it over for the Carpet Floor Head Insert.
	If using the Carpet Floor Head Insert and it is still hard to push, this may be due to the strong suction of your vacuum cleaner.
	Rather than using brute force to push the Floor Head, lift the Floor Head momentarily to allow air to flow into the vacuum cleaner releasing the built-up suction pressure, then continue vacuuming.
	or Slide open the vacuum Suction Relief Valve located on the hose handle. This will reduce suction to the floor head.
Mist being ejected from Air Outlet Port when Vacuuming Water	This indicates that there is too much water in the dust canister. Empty water from the dust canister.
Water is being Ejected from Air Outlet Port when Vacuuming Water	This appliance is only designed to vacuum up small liquid spills. Refer Section " WARNINGS "
Air Blows instead of Sucks	Hose is connected to the Air Exhaust. Remove and attach to the Suction Inlet.
Air Sucks instead of Blows	Hose is connected to the Suction Inlet. Remove and attach to the Air Exhaust.
No Suction if the vacuum cleaner has fallen over.	The Water Float has blocked the air inlet. Turn off the motor, wait until the motor fully stops to allow the water float to drop, and then start the vacuum cleaner again.

<p>Static Shock</p>	<p>In some rare instances, some users may feel an electric discharge when touching or using the vacuum cleaner during or after use. This is a well know phenomenon of Static Electricity discharge that happens mostly when the user vacuums a synthetic fibre carpet or other synthetic surfaces. It can also be more prevalent in dry and cool environments. Although the feeling of the Static Electricity can be unpleasant for the user, it is not dangerous and is not a fault of the vacuum cleaner. If this static discharge is a problem for the user, the user could try wearing insulating footwear during vacuuming (i.e., rubber or leather soles), or increase the humidity and/or heat level in the surrounding environment.</p> <p>There is a small chain that is welded to the bottom of the metal dust canister.</p> <p>This chain is designed to stay in contact with the floor and as such will discharge any static electricity to ground depending on the floor surface type.</p>
---------------------	---------------------------------------------------------------------------------------------------------------------------------------------------------------------------------------------------------------------------------------------------------------------------------------------------------------------------------------------------------------------------------------------------------------------------------------------------------------------------------------------------------------------------------------------------------------------------------------------------------------------------------------------------------------------------------------------------------------------------------------------------------------------------------------------------------------------------------------------------------------------------------------------------------------------------------------------------------------------------------------------------------

16 Warranty Against Defect

12 Month Warranty

Thank you for your purchase.

Your new product is warranted to be free from defects in materials and workmanship for the period stated above, from the date of purchase, provided that the product is used in accordance with accompanying recommendations or instructions where provided. This warranty is in addition to your rights under the Australian Consumer Law. For New Zealand customers, this warranty is in addition to statutory rights observed under New Zealand legislation.

We will provide you with your choice of a refund, repair (where possible) or exchange (availability dependent) for this product if it becomes defective within the warranty period. The business will bear the reasonable expense of claiming the warranty. This warranty will no longer apply where the defect is a result of alteration, accident, misuse, abuse, or neglect.

Please retain your receipt as proof of purchase and contact our Customer Service Centre as listed below, for the entity you purchased this product from, for any difficulties with your product. Warranty claims and claims for expenses incurred in returning this product can be addressed to the respective Customer Service Centre.

Our goods come with guarantees that cannot be excluded under the Australian Consumer Law. You are entitled to a replacement or refund for a major failure and compensation for any other reasonably foreseeable loss or damage. You are also entitled to have the goods repaired or replaced if the goods fail to be of acceptable quality and the failure does not amount to a major failure.

Contact for Kmart purchases	Contact for Target purchases
Kmart Australia Ltd. C/- Customer Service Centre, 690 Springvale Road, Mulgrave Vic 3170 Customer Service: 1800 124 125 (Australia) or 0800 945 995 (New Zealand) or via Customer Help at kmart.com.au	Target Australia Pty Ltd. C/- Customer Service Centre, 2 Kendall Street, Williams Landing, Vic, 3027 Customer Service: 1300 753 567 or via Customer Help at target.com.au/help/contact-us

IMPORTANT! For all technical queries or difficulties in operating the product and for spare parts, contact H.E. Group customer service 1300 105 888 (Australia) and 09 8870 447 (New Zealand).

