

# anko

## HIGH DEFINITION DASH CAMERA

### Instruction manual

K: 43527816 | T: 70848090

Model: JLR-79415



**Packing list:** 1PC DASH CAM, 1PC BRACKET, 1PC 32GB TF CARD INCLUDED, 1PC TYPE-C TO CAR CHARGER CABLE, 1PC MANUAL.

Please read all the information carefully before you use the product and keep the manual for future reference as it contains important information.

# Product Specification

- 2.0" LCD Screen
- 150mAh Li-ion rechargeable battery
- Front camera up to 1920\*1080P
- Inside camera up to VGA 640\*480
- Photo file format: JPEG
- Video file format: AVI
- Supports up to 32GB TF card (included)

# Product diagram



# Installation:

- 1 Turn off the engine.
2. Insert memory card.



#### Note:

- ✧ Gently push the TF card into the slot until it locks into place as above picture showing:
- ✧ Insert the TF card in incorrect direction could damage the TF card slot
- ✧ It supports from 4GB to 32GB TF memory card (ONLY included 1pc TF 32GB card, others need to be purchased separately)
- ✧ Please use the high-speed TF card (Class 10 above).
- ✧ Memory card is a small part which may be a choking hazard. Don't put into the mouth.
- ✧ If cannot read the TF card, please take it out and insert again and check the direction is correct.

### 3. Assemble the dash cam

Please assemble the dash cam as below picture showing.

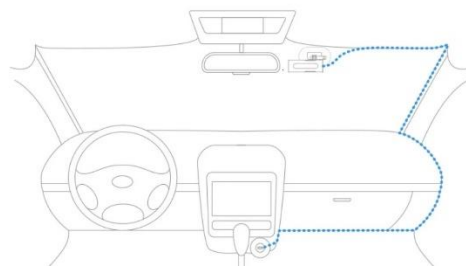

- 3.1. Step 1 to 2: Assemble the bracket.
- 3.2. Step 3 to 4: fix the bracket to dash cam
- 3.3. Step 5 to 6: fix the dash cam on the windshield
- 3.4. Plug the power cord into the cigarette lighter socket and the dash cam.

**Note:**

- Remove any foreign matter and clean and dry the windshield before installation.
- Assemble the bracket on the dash cam firmly
- Put the suction face on the front windshield and push the button down to fix it.
- Turn on the engine and check the dash cam is operating properly.





**Warning:**



- ✧ When wiring, extend the charging line along the edge of the car door frame and carpet under the car laying.
- ✧ Adjust the angle of the lens by rotating the body of the dash cam. We recommend pointing the lens slightly downwards ( $\approx 10^\circ$  below horizontal), so as to record video with a 6:4 road to background ratio.
- ✧ Do not install the product in a location where it can obstruct the driver's field of vision.

**4. Turn on the engine**

Checking if the dash cam is operating properly.

**Buttons Introductions:**

	Power Button	long press to switch on/off the device, short press to turn on/off screen
	Menu/Camera/Playback Button	<p>Short press to switch video mode, camera mode, playback mode</p> <p><b>Video mode:</b> Short press <b>[OK]</b> to start/stop recording, Long press <b>[M]</b> to enter video menu setup</p> <p><b>Camera mode:</b> Short press <b>[OK]</b> to take photo, Long press <b>[M]</b> to enter camera menu setup</p> <p><b>Playback mode:</b> Short press <b>[OK]</b> to play/pause the video, Long press <b>[M]</b> to enter playback menu setup</p>
	Next Button	<p>switch to next option in menu/playback interface;</p> <p>Short press to switch inside view, front view, inside and front view</p>
	Previous Button	<p>Switch to previous option in menu/playback interface;</p> <p>short press to turn on/off recording function under video mode</p>

<b>[OK]</b>	Confirm button	Short press to confirm in the menu interface.  Short press to start/stop in video/camera/ playback mode
<b>[R]</b>	Reset button	If the dash cam crashes or other abnormal situations, use a needle to short press <b>[R]</b> to shut down device and press  to restart device.
	Day & Night button	Select Day or Night mode as you need

## Video Menu

Long press **[M]** to enter video menu setup under video mode.

Setup	Mode	Function details
Resolution	1080P FHD 720P VGA	1080P FHD:1980*1080 720P: 1280*720 VGA: 640*480
Loop recording	Off 1minutes 2minutes 3minutes 5minutes	Off: no loop recording 1/2/3/5 minutes: Select the loop recording mode you need
Exposure	Exposure	+2.0, +5/3, +4/3, +1.0, +2/3, +1/3, +0.0, -1/3, -2/3, -1.0, -4/3, -5/3, -2.0
Motion detection	Off/On	Off: Will not take video under standby mode when an object movement is detected On: Will take video under standby mode when an object movement is detected
Record Audio	Off/On	Off: turn off sound record On: turn on sound record
Date stamp	Off/On	Off: Date stamp will not display on video On: Date stamp will display on video
G-sensor	Off/2G/4G/8G/	Off: Turn off G-sensor, No video during accident/collision 2G: G-sensor on with low sensitivity 4G: G-sensor on with middle sensitivity 8G: G-sensor on with high sensitivity Note: The video will be automatically saved and can't be overwritten while car collision/accident.

**Note:**

Press Day & Night button to switch the Day or Night function of video recording.

## Camera Menu:

Long press **[M]** to enter camera menu setup under video mode.

Setup	Mode	Function details
Resolution	1.3M 1280X960 2MHD 1920 X 1080	Select the resolution you need

When the camera is powered on, short press the **[OK]** button to stop recording, short press **[M]**

to enter the camera mode, and short press the **[OK]** button to take a photo. If you need to switch

back to the video mode, short press the **[M]** button several times.

**Note:**

Press Day & Night button to switch the Day or Night function of image during shooting.

## Playback Menu

Long press **[M]** to enter playback menu setup under playback mode.

Setup	Mode	Function details
Delete	Delete Current Delete All	Delete Current: Delete the current video/ photo Delete All: Delete all video/ photos
Protect	Lock Current Unlock Current Lock All Unlock All	Lock Current: Lock the current video Unlock Current: Unlock the current video Lock All: Lock all videos Unlock All: Unlock all videos Note: only lock video.

## Function Menu

Long press **[M]** to enter menu setup under any mode, then short press **[M]** to enter the function menu setup

Setup	Mode	Function details
-------	------	------------------

Park Mode	Off/On	Off: Will not take videos in parking mode On: Will take videos in parking mode
Date/Time	YY/MM/DD MM/DD/YY DD/MM/YY	Adjust Year/ Month/ Date/ Hours/ Minutes/ Seconds with 3 types display  <b>Note</b> For effective recording and evidence collection, please set the correct date and time immediately before using the machine.
Auto power off	Off 1minutes 3minutes	Off: will not shut down automatically 1/3 minutes: will automatically shut down after 1/3 minutes
Screen saver	Off 3 minutes 5 minutes 10 minutes	Off: Display screen will not be turn off. 3/5/10 minutes: Display screen will be turn off after 3/5/10 minutes
Beep Sound	Off On	Off: turn off the press button sound On: turn on the press button sound
Language	Multi languages	Choose the language you need
Frequency	50Hz/ 60Hz	Choose the frequency you want
Format	Cancel/OK	Format TF card  <b>Caution</b> Back up important video files such as event recording files before formatting the TF card. If you format the TF card, all files stored in the TF card will be deleted. Your saved settings will not be affected
Default setting	Cancel/Ok	Return menu settings to defaults
Version	Machine software version	

## Function instructions:

### Loop recording function:

Turn on the car engine. The dash cam will automatically turn on and start recording. Video files are stored on the TF card. When the TF card fills up, the newest video files will start to replace the oldest video files.

**Note:** Please turn on loop recording in main menu, or else it will not take the video.

### Motion Detection Function

In standby mode, enter the menu screen to turn on the motion detection mode. When the front lens senses movement in the surrounding area after powered on, the machine enters into recording state, and the system stops recording after around 10 seconds.

Note:

Please make sure the TF card is inserted.

It can only be active once per time and if it is interrupted, it need to turn on the function in menu set up again.

It will stop recording if no movement is detective.

## G-Sensor Function

The dash cam has a built-in a gravity sensor (G-sensor). If a serious vehicle collision occurs, the recorder will lock the video data of the accident, the locked video will be saved as a special file, which will not be overwritten in a loop.

**Note:** G-sensor can only be active when the dash cam is turn on to record.

## Parking Monitor:

To achieve this function, the Parking monitoring functions must be turned on in the main menu. If the car is hit or struck while stopped, the recorder will detect the vibration and turn on to automatically record a video and lock it.

**Note:**

Please be sure to turn on the Parking function in menu setup.

When it is not connected to the power supply, it will automatically shut down after recording a video. When connected to the power supply, it will play the first video and then record normally.

## Connecting computer to transfer files:

1. Recommended to use card reader (need to purchase separately).
2. Use data cable (need to purchase separately) to connect dash cam and computer

## Frequently asked questions

Machine appears "file error" message	Mainly be the TF card problem. Setting menu- select default settings – format the memory card – restart machine
Horizontal stripes appear on the screen	Please select correct power supply frequency 50HZ (PAL)



How to properly turn on the 24-hour parking monitoring function	Please do not turn it on during normal driving, as it may cause the machine to shut down automatically or freeze. It needs to be turned on only after parking.
Night shots are not clear enough	Dash cam recording depends on strong external light sources (such as street lights and car lights).
The machine always reverts to the default date and time	Fully charge the device when it is turned off. You can use a car charger or mobile power bank to replenish the power.
Why are there missing seconds in the video file?	Please turn off the motion detection function/ open the loop recording function
Why did the machine suddenly shut down automatically during recording?	Please turn off the parking monitoring function first. The temperature of the operating environment exceeding 70 °C will also cause automatic shutdown.

## Safety instruction

1. Keep the appliance away from all hot surfaces and naked flames.
2. Always put the appliance on a level, stable, clean, dry surface.
3. Protect the appliance from extreme heat and cold, dust, direct sunlight, humidity and drops or jets of water.
4. Do not immerse the appliance in water or in other liquids.
5. Do not open the housing under any circumstances.
6. Do not introduce any objects into the interior of the housing.
7. Should the device malfunction due to electrostatic discharge or a short power surge, disconnect it from your computer and then reconnect it again.
8. Please wipe the surface stains with dry cloth. When cleaning this product, ensure that the charger is disconnected.
9. Regular checking cables and product in case it's damaged. If it is damaged, stop using immediately
10. Built-in battery is not removable and replaceable, if damaged should contact service and repair.

## 12 Month Warranty

Thank you for your purchase.

Your new product is warranted to be free from defects in materials and workmanship for the period stated above, from the date of purchase, provided that the product is used in accordance with accompanying recommendations or instructions where provided.

This warranty is in addition to your rights under the Australian Consumer Law.

For New Zealand customers, this warranty is in addition to statutory rights observed under New Zealand legislation.

We will provide you with your choice of a refund, repair (where possible) or exchange (availability dependent) for this product if it becomes defective within the warranty period. The business will bear the reasonable expense of claiming the warranty.

This warranty will no longer apply where the defect is a result of alteration, accident, misuse, abuse or neglect.

Please retain your receipt as proof of purchase and contact our Customer Service Centre as listed below, for the entity you purchased this product from, for any difficulties with your product.

Warranty claims and claims for expense incurred in returning this product can be addressed to the respective Customer Service Centre.

Our goods come with guarantees that cannot be excluded under the Australian Consumer Law. You are entitled to a replacement or refund for a major failure and compensation for any other reasonably foreseeable loss or damage.

You are also entitled to have the goods repaired or replaced if the goods fail to be of acceptable quality and the failure does not amount to a major failure.

<b>Contact for Kmart purchases</b>	<b>Contact for Target purchases</b>
Kmart Australia Ltd. C/- Customer Service Centre 690 Springvale Road, Mulgrave Vic 3170 Customer Service: 1800 124 125 (Australia) or 0800 945 995 (New Zealand) or via Customer Help at <a href="http://kmart.com.au">kmart.com.au</a>	Target Australia Pty Ltd C/- Customer Service Centre 2 Kendall Street, Williams Landing, Vic, 3027 Customer Service: 1300 753 567 or via Customer Help at <a href="http://target.com.au/help/contact-us">target.com.au/help/contact-us</a>